

Content

Description	Page
• Qualities and Applications	150
• Flap wheels of abrasive cloth	191
• Flap wheels of abrasive cloth for angle grinder	192
• Flap wheels of abrasive fleece/ abrasive cloth combination	192
• Fleece mops	197
• Rolls manufactured of abrasive fleece	197

High Performance marking

High Performance

Ordering example:

Packing unit:
1 pcs. per type

The High Performance products are additionally marked on the table with the High Performance heading

Further information on page 4.

Information

LSL, Flap Wheels of abrasive cloth (special manufacture)

These wheels with various bore dimensions can be used on both hand-held and floor-stand type machines. The type LSL consists of individual flaps imbedded radially into a very substantial resin-based core.

Please take note of the rotational direction!

Examples of application:

- preparation work
- deburring
- de-rusting
- prefinishing
- graining
- keying

LSL, Flap Wheels of abrasive cloth for angle grinder

Advantages:

- Fits onto standard angle grinders
- Replaces the use of shaft mounted flap wheels (where no straight grinder is available)
- No flange needed
- Ideal for welding seams on Stainless Steel (tanks)

Examples of application:

- de-rusting, removal of surface coatings and oxidise layers
- cleaning of welding seams
- grinding in the tank industry
- grinding in the assembling industry

Application info:

Only to be used on the periphery of the wheel

LSV, Grinding wheels of abrasive fleece (special manufacture)

These wheels with various bore dimensions can be used on both hand-held and floor-stand type machines. The LSV consists of abrasive impregnated fleece flaps. A special type of fleece gives flexibility to the tools which easily conforms to the individual workpiece profile.

Examples of application:

- matting
- conditioning
- polishing
- finishing
- final surface finishing

LSM, Flap wheels of abrasive fleece with abrasive cloth (special manufacture)

These wheels with various bore dimensions can be used on both hand-held and floor-stand type machines.

Due to the combination of coated abrasive and abrasive fleece greater stock removal is achieved compared to the product type LSV. Please take note of the rotational direction!

Examples of application:

- preparation work
- de-rusting
- pre-finishing
- graining
- keying

LSL, Flap Wheels of abrasive cloth (special manufacture)

Ordering example: LSL 125025 NK 60 Bore 13

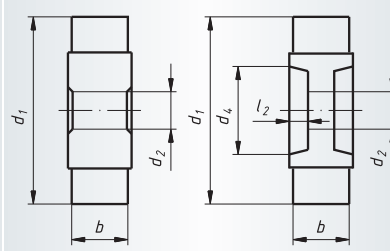

Packing unit:

Minimum ordering quantity 25 pcs. per type

V_{max} : 50 m/s for stationary machines

V_{rec} : 30 m/s off-hand application

* for stationary machines

Other dimensions can be supplied on request – from 80 mm to max. 400 mm.

NK = reg. Aluminium Oxide

Description	Grits	d ₁ mm	b mm	Bore d ₂ mm	recess on both sides d ₄ mm	recess on both sides l ₂ mm	n recom. (1/min)	n max. (1/min) *	recommended for	
LSL 125025	NK 60	125	25	13-16-20	---	---	4.500	7.600	① ② ③ ④ ⑤ ⑥ ⑦ ⑧	▲
LSL 125025	NK 80	125	25	13-16-20	---	---	4.500	7.600	① ② ③ ④ ⑤ ⑥ ⑦ ⑧	▲
LSL 125025	NK 120	125	25	13-16-20	---	---	4.500	7.600	① ② ③ ④ ⑤ ⑥ ⑦ ⑧	▲
LSL 125025	NK 150	125	25	13-16-20	---	---	4.500	7.600	① ② ③ ④ ⑤ ⑥ ⑦ ⑧	▲
LSL 125025	NK 240	125	25	13-16-20	---	---	4.500	7.600	① ② ③ ④ ⑤ ⑥ ⑦ ⑧	▲
LSL 150050	NK 60	150	50	13-16-20	47	18	3.800	6.300	① ② ③ ④ ⑤ ⑥ ⑦ ⑧	▲
LSL 150050	NK 80	150	50	13-16-20	47	18	3.800	6.300	① ② ③ ④ ⑤ ⑥ ⑦ ⑧	▲
LSL 150050	NK 120	150	50	13-16-20	47	18	3.800	6.300	① ② ③ ④ ⑤ ⑥ ⑦ ⑧	▲
LSL 150050	NK 150	150	50	13-16-20	47	18	3.800	6.300	① ② ③ ④ ⑤ ⑥ ⑦ ⑧	▲
LSL 150050	NK 240	150	50	13-16-20	47	18	3.800	6.300	① ② ③ ④ ⑤ ⑥ ⑦ ⑧	▲
LSL 165050	NK 60	165	50	13-16-20	47	18	3.400	5.700	① ② ③ ④ ⑤ ⑥ ⑦ ⑧	▲
LSL 165050	NK 80	165	50	13-16-20	47	18	3.400	5.700	① ② ③ ④ ⑤ ⑥ ⑦ ⑧	▲
LSL 165050	NK 120	165	50	13-16-20	47	18	3.400	5.700	① ② ③ ④ ⑤ ⑥ ⑦ ⑧	▲
LSL 165050	NK 150	165	50	13-16-20	47	18	3.400	5.700	① ② ③ ④ ⑤ ⑥ ⑦ ⑧	▲
LSL 165050	NK 240	165	50	13-16-20	47	18	3.400	5.700	① ② ③ ④ ⑤ ⑥ ⑦ ⑧	▲
LSL 200025	NK 60	200	25	20-25-32	71	10	2.800	4.700	① ② ③ ④ ⑤ ⑥ ⑦ ⑧	▲
LSL 200025	NK 80	200	25	20-25-32	71	10	2.800	4.700	① ② ③ ④ ⑤ ⑥ ⑦ ⑧	▲
LSL 200025	NK 120	200	25	20-25-32	71	10	2.800	4.700	① ② ③ ④ ⑤ ⑥ ⑦ ⑧	▲
LSL 200025	NK 150	200	25	20-25-32	71	10	2.800	4.700	① ② ③ ④ ⑤ ⑥ ⑦ ⑧	▲
LSL 200025	NK 240	200	25	20-25-32	71	10	2.800	4.700	① ② ③ ④ ⑤ ⑥ ⑦ ⑧	▲
LSL 200050	NK 60	200	50	20-25-32	71	18	2.800	4.700	① ② ③ ④ ⑤ ⑥ ⑦ ⑧	▲
LSL 200050	NK 80	200	50	20-25-32	71	18	2.800	4.700	① ② ③ ④ ⑤ ⑥ ⑦ ⑧	▲
LSL 200050	NK 120	200	50	20-25-32	71	18	2.800	4.700	① ② ③ ④ ⑤ ⑥ ⑦ ⑧	▲
LSL 200050	NK 150	200	50	20-25-32	71	18	2.800	4.700	① ② ③ ④ ⑤ ⑥ ⑦ ⑧	▲
LSL 200050	NK 240	200	50	20-25-32	71	18	2.800	4.700	① ② ③ ④ ⑤ ⑥ ⑦ ⑧	▲

LSL, Flap Wheels of abrasive cloth for angle grinder Ordering example: A2280125200040



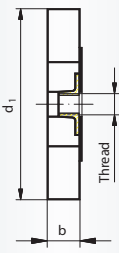

Packing unit:
5 pcs. per type
 V_{max} : 80 m/s
NK = reg. Aluminium Oxide

Description	Grits	d ₁ mm	b mm	Thread	n recom. (1/min)	n max. (1/min)	Product-Number	recommended for	
LSL 125020	NK 40	125	20	M14	9.600	12.200	A2280125200040	① ② ③ ④ ⑤ ⑥ ⑦ ⑧	■
LSL 125020	NK 60	125	20	M14	9.600	12.200	A2280125200060	① ② ③ ④ ⑤ ⑥ ⑦ ⑧	■
LSL 125020	NK 80	125	20	M14	9.600	12.200	A2280125200080	① ② ③ ④ ⑤ ⑥ ⑦ ⑧	■
LSL 125020	NK 120	125	20	M14	9.600	12.200	A2280125200120	① ② ③ ④ ⑤ ⑥ ⑦ ⑧	■

Advantages:

- Fits onto standard angle grinders
- Replaces the use of shaft mounted flap wheels (where no straight grinder is available)
- No flange needed
- Ideal for welding seams on Stainless Steel (tanks)

Application examples:

- De-rusting, removal of surface coatings and oxidise layers
- Cleaning of welding seams
- Grinding in the tank industry
- Grinding in the assembling industry

Application info:
Only to be used on the periphery of the wheel

LSV, Grinding wheels of abrasive fleece (special manufacture) Ordering example: LSV 100050 A 104 W Bore 13



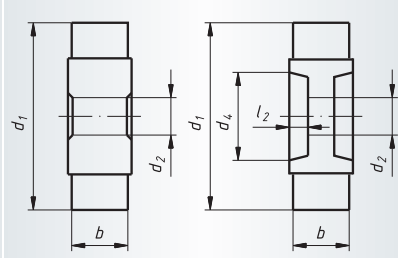

Packing unit:
Minimum ordering quantity 25 pcs. per type
 V_{max} : 35 m/s
Other dimensions, bores or qualities, e.g. "very hard" or "Poly Urethane-foamed" are available on request. Possible diameters 80 mm to max. 400 mm.
A = reg. Aluminium Oxide
C = Silicon carbide

Description	Grits	Quality	d ₁ mm	b mm	Bore d ₂ mm	recess on both sides d ₄ mm	recess on both sides l ₂ mm	n recom. (1/min)	n max. (1/min)	recommended for	
LSV 100050	A 104 W	soft	100	50	13-16-20	---	---	3.000	6.000	① ② ③ ④ ⑤ ⑥ ⑦ ⑧	▲
LSV 100050	A 106 W	soft	100	50	13-16-20	---	---	3.000	6.000	① ② ③ ④ ⑤ ⑥ ⑦ ⑧	▲
LSV 100050	A 107 W	soft	100	50	13-16-20	---	---	3.000	6.000	① ② ③ ④ ⑤ ⑥ ⑦ ⑧	▲
LSV 100050	C 204 W	soft	100	50	13-16-20	---	---	3.000	6.000	① ② ③ ④ ⑤ ⑥ ⑦ ⑧	▲
LSV 100050	C 206 W	soft	100	50	13-16-20	---	---	3.000	6.000	① ② ③ ④ ⑤ ⑥ ⑦ ⑧	▲
LSV 100050	C 207 W	soft	100	50	13-16-20	---	---	3.000	6.000	① ② ③ ④ ⑤ ⑥ ⑦ ⑧	▲
LSV 100050	A 104 M	medium	100	50	13-16-20	---	---	3.000	6.000	① ② ③ ④ ⑤ ⑥ ⑦ ⑧	▲
LSV 100050	A 106 M	medium	100	50	13-16-20	---	---	3.000	6.000	① ② ③ ④ ⑤ ⑥ ⑦ ⑧	▲
LSV 100050	A 107 M	medium	100	50	13-16-20	---	---	3.000	6.000	① ② ③ ④ ⑤ ⑥ ⑦ ⑧	▲
LSV 100050	C 204 M	medium	100	50	13-16-20	---	---	3.000	6.000	① ② ③ ④ ⑤ ⑥ ⑦ ⑧	▲

LSV, Grinding wheels of abrasive fleece (special manufacture)

Ordering example: LSV 100050 C 206 M Bore 13

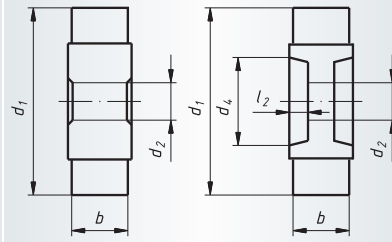

Packing unit:

Minimum ordering quantity 25 pcs. per type

V_{max} : 35 m/s

Other dimensions, bores or qualities, e.g. "very hard" or "Poly Urethane-foamed" are available on request. Possible diameters 80 mm to max. 400 mm.

A = reg. Aluminium Oxide
C = Silicon carbide

Description	Grits	Quality	d ₁ mm	b mm	Bore d ₂ mm	recess on both sides d ₄ mm	recess on both sides l ₂ mm	n recom. (1/min)	n max. (1/min)	recommended for	
LSV 100050	C 206 M	medium	100	50	13-16-20	---	---	3.000	6.000	1 2 3 4 5 6 7 8	▲
LSV 100050	C 207 M	medium	100	50	13-16-20	---	---	3.000	6.000	1 2 3 4 5 6 7 8	▲
LSV 100050	A 104 H	hard	100	50	13-16-20	---	---	3.000	6.000	1 2 3 4 5 6 7 8	▲
LSV 100050	A 106 H	hard	100	50	13-16-20	---	---	3.000	6.000	1 2 3 4 5 6 7 8	▲
LSV 100050	A 107 H	hard	100	50	13-16-20	---	---	3.000	6.000	1 2 3 4 5 6 7 8	▲
LSV 100050	C 204 H	hard	100	50	13-16-20	---	---	3.000	6.000	1 2 3 4 5 6 7 8	▲
LSV 100050	C 206 H	hard	100	50	13-16-20	---	---	3.000	6.000	1 2 3 4 5 6 7 8	▲
LSV 100050	C 207 H	hard	100	50	13-16-20	---	---	3.000	6.000	1 2 3 4 5 6 7 8	▲
LSV 150050	A 104 W	soft	150	50	13-16-20	47	18	2.000	4.000	1 2 3 4 5 6 7 8	▲
LSV 150050	A 106 W	soft	150	50	13-16-20	47	18	2.000	4.000	1 2 3 4 5 6 7 8	▲
LSV 150050	A 107 W	soft	150	50	13-16-20	47	18	2.000	4.000	1 2 3 4 5 6 7 8	▲
LSV 150050	C 204 W	soft	150	50	13-16-20	47	18	2.000	4.000	1 2 3 4 5 6 7 8	▲
LSV 150050	C 206 W	soft	150	50	13-16-20	47	18	2.000	4.000	1 2 3 4 5 6 7 8	▲
LSV 150050	C 207 W	soft	150	50	13-16-20	47	18	2.000	4.000	1 2 3 4 5 6 7 8	▲
LSV 150050	A 104 M	medium	150	50	13-16-20	47	18	2.000	4.000	1 2 3 4 5 6 7 8	▲
LSV 150050	A 106 M	medium	150	50	13-16-20	47	18	2.000	4.000	1 2 3 4 5 6 7 8	▲
LSV 150050	A 107 M	medium	150	50	13-16-20	47	18	2.000	4.000	1 2 3 4 5 6 7 8	▲
LSV 150050	C 204 M	medium	150	50	13-16-20	47	18	2.000	4.000	1 2 3 4 5 6 7 8	▲
LSV 150050	C 206 M	medium	150	50	13-16-20	47	18	2.000	4.000	1 2 3 4 5 6 7 8	▲
LSV 150050	C 207 M	medium	150	50	13-16-20	47	18	2.000	4.000	1 2 3 4 5 6 7 8	▲
LSV 150050	A 104 H	hard	150	50	13-16-20	47	18	2.000	4.000	1 2 3 4 5 6 7 8	▲
LSV 150050	A 106 H	hard	150	50	13-16-20	47	18	2.000	4.000	1 2 3 4 5 6 7 8	▲
LSV 150050	A 107 H	hard	150	50	13-16-20	47	18	2.000	4.000	1 2 3 4 5 6 7 8	▲
LSV 150050	C 204 H	hard	150	50	13-16-20	47	18	2.000	4.000	1 2 3 4 5 6 7 8	▲
LSV 150050	C 206 H	hard	150	50	13-16-20	47	18	2.000	4.000	1 2 3 4 5 6 7 8	▲
LSV 150050	C 207 H	hard	150	50	13-16-20	47	18	2.000	4.000	1 2 3 4 5 6 7 8	▲
LSV 160050	A 104 W	soft	160	50	13-16-20	47	18	1.900	3.800	1 2 3 4 5 6 7 8	▲
LSV 160050	A 106 W	soft	160	50	13-16-20	47	18	1.900	3.800	1 2 3 4 5 6 7 8	▲
LSV 160050	A 107 W	soft	160	50	13-16-20	47	18	1.900	3.800	1 2 3 4 5 6 7 8	▲
LSV 160050	C 204 W	soft	160	50	13-16-20	47	18	1.900	3.800	1 2 3 4 5 6 7 8	▲
LSV 160050	C 206 W	soft	160	50	13-16-20	47	18	1.900	3.800	1 2 3 4 5 6 7 8	▲
LSV 160050	C 207 W	soft	160	50	13-16-20	47	18	1.900	3.800	1 2 3 4 5 6 7 8	▲
LSV 160050	A 104 M	medium	160	50	13-16-20	47	18	1.900	3.800	1 2 3 4 5 6 7 8	▲
LSV 160050	A 106 M	medium	160	50	13-16-20	47	18	1.900	3.800	1 2 3 4 5 6 7 8	▲
LSV 160050	A 107 M	medium	160	50	13-16-20	47	18	1.900	3.800	1 2 3 4 5 6 7 8	▲
LSV 160050	C 204 M	medium	160	50	13-16-20	47	18	1.900	3.800	1 2 3 4 5 6 7 8	▲
LSV 160050	C 206 M	medium	160	50	13-16-20	47	18	1.900	3.800	1 2 3 4 5 6 7 8	▲
LSV 160050	C 207 M	medium	160	50	13-16-20	47	18	1.900	3.800	1 2 3 4 5 6 7 8	▲

LSV, Grinding wheels of abrasive fleece (special manufacture)

Ordering example: LSV 160050 A 104 H Bore 13

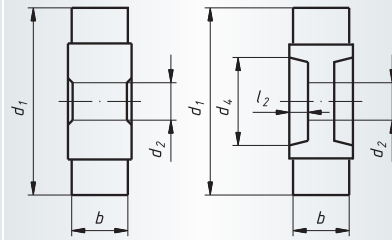

Packing unit:

Minimum ordering quantity 25 pcs. per type

V_{max} : 35 m/s

Other dimensions, bores or qualities, e.g. "very hard" or "Poly Urethane-foamed" are available on request. Possible diameters 80 mm to max. 400 mm.

A = reg. Aluminium Oxide
C = Silicon carbide

Description	Grits	Quality	d ₁ mm	b mm	Bore d ₂ mm	recess on both sides d ₄ mm	recess on both sides l ₂ mm	n recom. (1/min)	n max. (1/min)	recommended for	
LSV 160050	A 104 H	hard	160	50	13-16-20	47	18	1.900	3.800	1 2 3 4 5 6 7 8	▲
LSV 160050	A 106 H	hard	160	50	13-16-20	47	18	1.900	3.800	1 2 3 4 5 6 7 8	▲
LSV 160050	A 107 H	hard	160	50	13-16-20	47	18	1.900	3.800	1 2 3 4 5 6 7 8	▲
LSV 160050	C 204 H	hard	160	50	13-16-20	47	18	1.900	3.800	1 2 3 4 5 6 7 8	▲
LSV 160050	C 206 H	hard	160	50	13-16-20	47	18	1.900	3.800	1 2 3 4 5 6 7 8	▲
LSV 160050	C 207 H	hard	160	50	13-16-20	47	18	1.900	3.800	1 2 3 4 5 6 7 8	▲
LSV 200025	A 104 W	soft	200	25	20-25-32	71	10	1.500	3.000	1 2 3 4 5 6 7 8	▲
LSV 200025	A 106 W	soft	200	25	20-25-32	71	10	1.500	3.000	1 2 3 4 5 6 7 8	▲
LSV 200025	A 107 W	soft	200	25	20-25-32	71	10	1.500	3.000	1 2 3 4 5 6 7 8	▲
LSV 200025	C 204 W	soft	200	25	20-25-32	71	10	1.500	3.000	1 2 3 4 5 6 7 8	▲
LSV 200025	C 206 W	soft	200	25	20-25-32	71	10	1.500	3.000	1 2 3 4 5 6 7 8	▲
LSV 200025	C 207 W	soft	200	25	20-25-32	71	10	1.500	3.000	1 2 3 4 5 6 7 8	▲
LSV 200025	A 104 M	medium	200	25	20-25-32	71	10	1.500	3.000	1 2 3 4 5 6 7 8	▲
LSV 200025	A 106 M	medium	200	25	20-25-32	71	10	1.500	3.000	1 2 3 4 5 6 7 8	▲
LSV 200025	A 107 M	medium	200	25	20-25-32	71	10	1.500	3.000	1 2 3 4 5 6 7 8	▲
LSV 200025	C 204 M	medium	200	25	20-25-32	71	10	1.500	3.000	1 2 3 4 5 6 7 8	▲
LSV 200025	C 206 M	medium	200	25	20-25-32	71	10	1.500	3.000	1 2 3 4 5 6 7 8	▲
LSV 200025	C 207 M	medium	200	25	20-25-32	71	10	1.500	3.000	1 2 3 4 5 6 7 8	▲
LSV 200025	A 104 H	hard	200	25	20-25-32	71	10	1.500	3.000	1 2 3 4 5 6 7 8	▲
LSV 200025	A 106 H	hard	200	25	20-25-32	71	10	1.500	3.000	1 2 3 4 5 6 7 8	▲
LSV 200025	A 107 H	hard	200	25	20-25-32	71	10	1.500	3.000	1 2 3 4 5 6 7 8	▲
LSV 200025	C 204 H	hard	200	25	20-25-32	71	10	1.500	3.000	1 2 3 4 5 6 7 8	▲
LSV 200025	C 206 H	hard	200	25	20-25-32	71	10	1.500	3.000	1 2 3 4 5 6 7 8	▲
LSV 200025	C 207 H	hard	200	25	20-25-32	71	10	1.500	3.000	1 2 3 4 5 6 7 8	▲
LSV 200050	A 104 W	soft	200	50	20-25-32	71	18	1.500	3.000	1 2 3 4 5 6 7 8	▲
LSV 200050	A 106 W	soft	200	50	20-25-32	71	18	1.500	3.000	1 2 3 4 5 6 7 8	▲
LSV 200050	A 107 W	soft	200	50	20-25-32	71	18	1.500	3.000	1 2 3 4 5 6 7 8	▲
LSV 200050	C 204 W	soft	200	50	20-25-32	71	18	1.500	3.000	1 2 3 4 5 6 7 8	▲
LSV 200050	C 206 W	soft	200	50	20-25-32	71	18	1.500	3.000	1 2 3 4 5 6 7 8	▲
LSV 200050	C 207 W	soft	200	50	20-25-32	71	18	1.500	3.000	1 2 3 4 5 6 7 8	▲
LSV 200050	A 104 M	medium	200	50	20-25-32	71	18	1.500	3.000	1 2 3 4 5 6 7 8	▲
LSV 200050	A 106 M	medium	200	50	20-25-32	71	18	1.500	3.000	1 2 3 4 5 6 7 8	▲
LSV 200050	A 107 M	medium	200	50	20-25-32	71	18	1.500	3.000	1 2 3 4 5 6 7 8	▲
LSV 200050	C 204 M	medium	200	50	20-25-32	71	18	1.500	3.000	1 2 3 4 5 6 7 8	▲
LSV 200050	C 206 M	medium	200	50	20-25-32	71	18	1.500	3.000	1 2 3 4 5 6 7 8	▲
LSV 200050	C 207 M	medium	200	50	20-25-32	71	18	1.500	3.000	1 2 3 4 5 6 7 8	▲
LSV 200050	A 104 H	hard	200	50	20-25-32	71	18	1.500	3.000	1 2 3 4 5 6 7 8	▲
LSV 200050	A 106 H	hard	200	50	20-25-32	71	18	1.500	3.000	1 2 3 4 5 6 7 8	▲

LSV, Grinding wheels of abrasive fleece (special manufacture) Ordering example: LSV 200050 A 107 H Bore 20

Packing unit:
 Minimum ordering quantity 25 pcs. per type
 V_{max} : 35 m/s
 Other dimensions, bores or qualities, e.g. "very hard" or "Poly Urethane-foamed" are available on request. Possible diameters 80 mm to max. 400 mm.
 A = reg. Aluminium Oxide
 C = Silicon carbide

Description	Grits	Quality	d ₁ mm	b mm	Bore d ₂ mm	recess on both sides d ₄ mm	recess on both sides l ₂ mm	n recom. (1/min)	n max. (1/min)	recommended for	
LSV 200050	A 107 H	hard	200	50	20-25-32	71	18	1.500	3.000	1 2 3 4 5 6 7 8	▲
LSV 200050	C 204 H	hard	200	50	20-25-32	71	18	1.500	3.000	1 2 3 4 5 6 7 8	▲
LSV 200050	C 206 H	hard	200	50	20-25-32	71	18	1.500	3.000	1 2 3 4 5 6 7 8	▲
LSV 200050	C 207 H	hard	200	50	20-25-32	71	18	1.500	3.000	1 2 3 4 5 6 7 8	▲

LSM, Flap wheels of abrasive fleece with abrasive cloth (special manufacture) Ordering example: LSM 080050 A 104/80 Bore 13

Packing unit:
 Minimum ordering quantity 25 pcs. per type
 V_{max} : 35 m/s
 Other dimensions, bores or qualities are available on request. Possible diameters 80 mm to max. 400 mm.
 A = reg. Aluminium Oxide
 C = Silicon carbide

Description	Grits	d ₁ mm	b mm	Bore d ₂ mm	recess on both sides d ₄ mm	recess on both sides l ₂ mm	n recom. (1/min)	n max. (1/min)	recommended for	
LSM 080050	A 104/80	80	50	10-13-16	---	---	3.800	7.600	1 2 3 4 5 6 7 8	▲
LSM 080050	A 106/150	80	50	10-13-16	---	---	3.800	7.600	1 2 3 4 5 6 7 8	▲
LSM 080050	A 107/240	80	50	10-13-16	---	---	3.800	7.600	1 2 3 4 5 6 7 8	▲
LSM 080050	C 204/80	80	50	10-13-16	---	---	3.800	7.600	1 2 3 4 5 6 7 8	▲
LSM 080050	C 206/150	80	50	10-13-16	---	---	3.800	7.600	1 2 3 4 5 6 7 8	▲
LSM 080050	C 207/240	80	50	10-13-16	---	---	3.800	7.600	1 2 3 4 5 6 7 8	▲
LSM 150050	A 104/80	150	50	13-16-20	47	18	2.000	4.000	1 2 3 4 5 6 7 8	▲
LSM 150050	A 106/150	150	50	13-16-20	47	18	2.000	4.000	1 2 3 4 5 6 7 8	▲
LSM 150050	A 107/240	150	50	13-16-20	47	18	2.000	4.000	1 2 3 4 5 6 7 8	▲
LSM 150050	C 204/80	150	50	13-16-20	47	18	2.000	4.000	1 2 3 4 5 6 7 8	▲
LSM 150050	C 206/150	150	50	13-16-20	47	18	2.000	4.000	1 2 3 4 5 6 7 8	▲
LSM 150050	C 207/240	150	50	13-16-20	47	18	2.000	4.000	1 2 3 4 5 6 7 8	▲
LSM 160050	A 104/80	160	50	13-16-20	47	18	1.900	3.800	1 2 3 4 5 6 7 8	▲
LSM 160050	A 106/150	160	50	13-16-20	47	18	1.900	3.800	1 2 3 4 5 6 7 8	▲
LSM 160050	A 107/240	160	50	13-16-20	47	18	1.900	3.800	1 2 3 4 5 6 7 8	▲
LSM 160050	C 204/80	160	50	13-16-20	47	18	1.900	3.800	1 2 3 4 5 6 7 8	▲
LSM 160050	C 206/150	160	50	13-16-20	47	18	1.900	3.800	1 2 3 4 5 6 7 8	▲
LSM 160050	C 207/240	160	50	13-16-20	47	18	1.900	3.800	1 2 3 4 5 6 7 8	▲

LSM, Flap wheels of abrasive fleece with abrasive cloth (special manufacture) Ordering example: LSM 200050 A 104/80 Bore 25

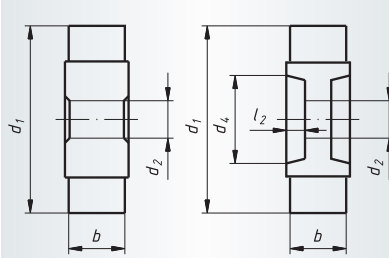

Packing unit:

Minimum ordering quantity 25 pcs. per type

V_{max} : 35 m/s

Other dimensions, bores or qualities are available on request. Possible diameters 80 mm to max. 400 mm.

A = reg. Aluminium Oxide

C = Silicon carbide

Description	Grits	d ₁ mm	b mm	Bore d ₂ mm	recess on both sides d ₄ mm	recess on both sides l ₂ mm	n recom. (1/min)	n max. (1/min)	recommended for	
LSM 200050	A 104/80	200	50	20-25-32	71	18	1.500	3.000	1 2 3 4 5 6 7 8	▲
LSM 200050	A 106/150	200	50	20-25-32	71	18	1.500	3.000	1 2 3 4 5 6 7 8	▲
LSM 200050	A 107/240	200	50	20-25-32	71	18	1.500	3.000	1 2 3 4 5 6 7 8	▲
LSM 200050	C 204/80	200	50	20-25-32	71	18	1.500	3.000	1 2 3 4 5 6 7 8	▲
LSM 200050	C 206/150	200	50	20-25-32	71	18	1.500	3.000	1 2 3 4 5 6 7 8	▲
LSM 200050	C 207/240	200	50	20-25-32	71	18	1.500	3.000	1 2 3 4 5 6 7 8	▲

FRV, Mops of abrasive fleece

Ordering example: FRV 20005 A 104 Bore 20

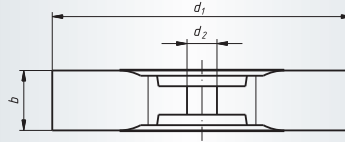

Packing unit:

Minimum ordering quantity 25 pcs. per type

A = reg. Aluminium Oxide

Description	Grits	Quality	d ₁ mm	b mm	d ₂ mm	n recom. (1/min)	n max. (1/min)	recommended for	
FRV 20050	A 104	medium	200	50	20-25-32	1.400	1.900	1 2 3 4 5 6 7 8	▲
FRV 20050	A 106	fine	200	50	20-25-32	1.400	1.900	1 2 3 4 5 6 7 8	▲
FRV 20050	A 107	very fine	200	50	20-25-32	1.400	1.900	1 2 3 4 5 6 7 8	▲
FRV 25050	A 104	medium	250	50	20-25-32	1.100	1.500	1 2 3 4 5 6 7 8	▲
FRV 25050	A 106	fine	250	50	20-25-32	1.100	1.500	1 2 3 4 5 6 7 8	▲
FRV 25050	A 107	very fine	250	50	20-25-32	1.100	1.500	1 2 3 4 5 6 7 8	▲
FRV 30060	A 104	medium	300	60	20-25-32	900	1.200	1 2 3 4 5 6 7 8	▲
FRV 30060	A 106	fine	300	60	20-25-32	900	1.200	1 2 3 4 5 6 7 8	▲
FRV 30060	A 107	very fine	300	60	20-25-32	900	1.200	1 2 3 4 5 6 7 8	▲

LUKAS Fleece Mops are manufactured from abrasive fleece and are used when a satin polish is required on stainless, chrome, nickel and non ferrous metals. They are also ideal for cleaning-up and enhancing painted and varnished surfaces in the wood and plastic industries. Furthermore, they are suited to the manufacture of stainless and aluminium containers supplied to the food industry.

The ideal operating speed lies between 10 – 20 m/s and the fleece mops should

be used with little pressure. They can be used with or without coolant. Operating with coolant extends the life of the fleece mop.

When using water as a coolant a matt surface is achieved; oil produces a satin finish. LUKAS Fleece Mops can be clamped together on a single spindle thus giving the overall width required.

LSW, Rolls manufactured of abrasive fleece

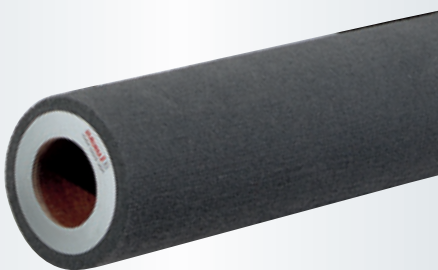

Rolls with a diameter of 100 to 400 mm and a width of 100 to 1.000 mm are available with various bores and qualities of abrasive fleece.

available on request

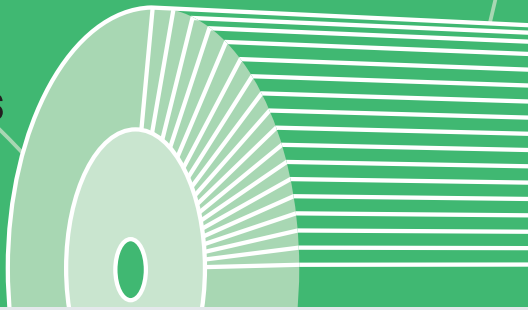

Content

Description	Page
• Qualities and Applications	150
• General Information	199
• Flap rolls of abrasive cloth	200
• Flap rolls of abrasive fleece	200
• Flap rolls of abrasive fleece/abrasive cloth combination	202
• Conditioning machine	202

High Performance marking

High Performance

Ordering example: A22881001000120

Packing unit:
1 pcs. per type

The High Performance products are additionally marked on the table with the High Performance heading

Further information on page 4.

Information

General

These rolls have a nineteen mm bore with four keyways; they are used on hand-held surface conditioning machines.

LSL, Flap rolls of abrasive cloth for conditioning machines

These tools consist of individual flaps which are radially embedded into a resin core.

Please take note of the rotational direction!

Examples of application:

- preparation work
- deburring
- de-rusting
- pre-finishing
- graining
- keying

LSV, Flap rolls of abrasive fleece for conditioning machines

This product type consists of abrasive fleece flaps; the special fleece gives the tool flexibility and conforms to the individual workpiece profile.

Examples of application:

- matting
- conditioning
- polishing
- finishing
- final finishing of the surface

LSF, Sinus-Abrasive rolls of abrasive fleece for conditioning machines

These tools are manufactured from strips of abrasive fleece which are wound in a wave pattern around the core; this configuration achieves an unblemished grained matt surface finish.

The special fleece makes the LSF flexible and conforms to the individual workpiece profile.

Examples of application:

- matting
- conditioning
- polishing
- finishing
- fine surface finishing

LSM, Flap rolls of abrasive fleece with abrasive cloth insert for conditioning machines

Due to the combination of coated abrasive and abrasive fleece, greater stock removal is achieved compared to the product type LSV.

Please take note of the rotational direction!

Examples of application:

- preparation work
- de-rusting
- pre-finishing
- graining
- keying

LSM, Flap rolls of abrasive fleece TF with abrasive cloth insert for conditioning machines

These wheels with various bore dimensions are particularly suited to stainless steel applications.

The reverse side of the reinforced abrasive fleece guarantees uniform wear of the fleece and the coated abrasive flaps.

Please take note of the rotational direction!

LSL, Flap rolls of abrasive cloth for conditioning machines

Ordering example: A2280100500040

				<p>Packing unit: LSL 100050 = 2 pcs. per type LSL 100100 = 1 pc. per type NK = reg. Aluminium Oxide</p>					
Description	Grits	d ₁ mm	b mm	d ₂ mm	n recom. (1/min)	n max. (1/min)	Product-Number	recommended for	
LSL 100050	NK 40	100	50	19	3.700	6.000	A2280100500040	① ② ③ ④ ⑤ ⑥ ⑦ ⑧	■
LSL 100050	NK 60	100	50	19	3.700	6.000	A2280100500060	① ② ③ ④ ⑤ ⑥ ⑦ ⑧	■
LSL 100050	NK 80	100	50	19	3.700	6.000	A2280100500080	① ② ③ ④ ⑤ ⑥ ⑦ ⑧	■
LSL 100100	NK 40	100	100	19	3.700	6.000	A22801001000040	① ② ③ ④ ⑤ ⑥ ⑦ ⑧	■
LSL 100100	NK 60	100	100	19	3.700	6.000	A22801001000060	① ② ③ ④ ⑤ ⑥ ⑦ ⑧	■
LSL 100100	NK 80	100	100	19	3.700	6.000	A22801001000080	① ② ③ ④ ⑤ ⑥ ⑦ ⑧	■

LSV, Flap rolls of abrasive fleece for conditioning machines

Ordering example: A2286100500104

				<p>Packing unit: LSV 100050 = 2 pcs. per type LSV 100100 = 1 pc. per type A = reg. Aluminium Oxide</p>					
Description	Grits	d ₁ mm	b mm	d ₂ mm	n recom. (1/min)	n max. (1/min)	Product-Number	recommended for	
LSV 100050	A 104	100	50	19	2.800	6.000	A2286100500104	① ② ③ ④ ⑤ ⑥ ⑦ ⑧	■
LSV 100050	A 106	100	50	19	2.800	6.000	A2286100500106	① ② ③ ④ ⑤ ⑥ ⑦ ⑧	■
LSV 100050	A 107	100	50	19	2.800	6.000	A2286100500107	① ② ③ ④ ⑤ ⑥ ⑦ ⑧	■
LSV 100100	A 104	100	100	19	2.800	6.000	A22861001000104	① ② ③ ④ ⑤ ⑥ ⑦ ⑧	■
LSV 100100	A 106	100	100	19	2.800	6.000	A22861001000106	① ② ③ ④ ⑤ ⑥ ⑦ ⑧	■
LSV 100100	A 107	100	100	19	2.800	6.000	A22861001000107	① ② ③ ④ ⑤ ⑥ ⑦ ⑧	■

LSF, Sinus-Abrasive rolls of abrasive fleece for conditioning machines

Ordering example: A2281100500104

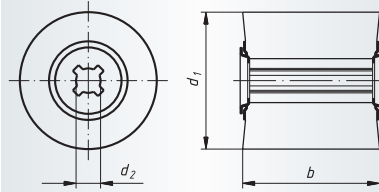

Packing unit:

LSF 100050 = 2 pcs. per type

LSF 100100 = 1 pc. per type

A = reg. Aluminium Oxide

C = Silicon carbide

Description	Grits	d ₁ mm	b mm	d ₂ mm	n recom. (1/min)	n max. (1/min)	Product-Number	recommended for	
LSF 100050	A 104	100	50	19	2.800	3.800	A2281100500104	① ② ③ ④ ⑤ ⑥ ⑦ ⑧	■
LSF 100050	A 106	100	50	19	2.800	3.800	A2281100500106	① ② ③ ④ ⑤ ⑥ ⑦ ⑧	■
LSF 100050	C 208	100	50	19	2.800	3.800	A2281100500208	① ② ③ ④ ⑤ ⑥ ⑦ ⑧ ⑨	■
LSF 100100	A 104	100	100	19	2.800	3.800	A22811001000104	① ② ③ ④ ⑤ ⑥ ⑦ ⑧	■
LSF 100100	A 106	100	100	19	2.800	3.800	A22811001000106	① ② ③ ④ ⑤ ⑥ ⑦ ⑧	■
LSF 100100	C 208	100	100	19	2.800	3.800	A22811001000208	① ② ③ ④ ⑤ ⑥ ⑦ ⑧ ⑨	■

High Performance

LSM, Flap rolls of abrasive fleece TF with abrasive cloth insert for conditioning machines *Ordering example: A22881001000120*

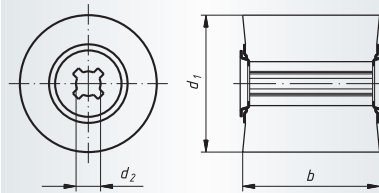
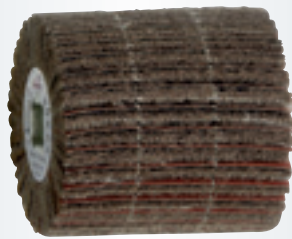

Packing unit:
1 pc. per type
TF = Special quality for INOX

Description	Grits	d ₁ mm	b mm	d ₂ mm	n recom. (1/min)	n max. (1/min)	Product-Number	recommended for
NEW LSM 100100	TF 120/80	100	100	19	2.800	6.000	A22881001000120	1 2 3 4 5 6 7 8

Ideal for surface finishing of metalsheet components such as stainless steel sinks and containers



LSM, Flap rolls of abrasive fleece with abrasive cloth insert for conditioning machines *Ordering example: A2288100500104*

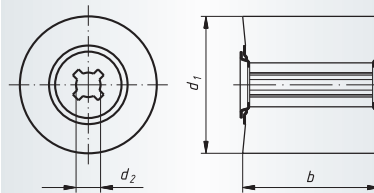

Packing unit:
LSM 100050 = 2 pcs. per type
LSM 100100 = 1 pc. per type
A = reg. Aluminium Oxide

Description	Grits	d ₁ mm	b mm	d ₂ mm	n recom. (1/min)	n max. (1/min)	Product-Number	recommended for
LSM 100050	A 104/80	100	50	19	2.800	6.000	A2288100500104	1 2 3 4 5 6 7 8
LSM 100050	A 106/150	100	50	19	2.800	6.000	A2288100500106	1 2 3 4 5 6 7 8
LSM 100050	A 107/240	100	50	19	2.800	6.000	A2288100500107	1 2 3 4 5 6 7 8
LSM 100100	A 104/80	100	100	19	2.800	6.000	A22881001000104	1 2 3 4 5 6 7 8
LSM 100100	A 106/150	100	100	19	2.800	6.000	A22881001000106	1 2 3 4 5 6 7 8
LSM 100100	A 107/240	100	100	19	2.800	6.000	A22881001000107	1 2 3 4 5 6 7 8



Conditioning machine

Ordering example: A39956037037



Packing unit:
1 pc. per type
Weight: approx. 2,9 kg

Description	Idle speed min ⁻¹	Power input W	Power output W	Max. tool diameter Ø mm	Tool width mm	Hole size mm	Product-Number
LP 1503 VR	1.200–3.700	1.200	700	115	100	19	A39956037037