



## Content

| Description                                       | Page | Description                          | Page |
|---|------|--------------------------------------|------|
| • Qualities and Applications                      | 150  | • Mini-Flap wheels of abrasive cloth | 181  |
| • General Information                             | 170  | • Air tools                          | 271  |
| • Mounted flap wheels of abrasive cloth           | 171  |                                      |      |
| • Mounted flap wheels of abrasive cloth, slotted  | 176  |                                      |      |
| • Mounted flap wheels of abrasive cloth, recessed | 176  |                                      |      |
| • Mounted flap wheels of abrasive cloth, SFE      | 177  |                                      |      |
| • Mounted flap wheels of abrasive cloth, SFC      | 178  |                                      |      |
| • Mounted flap wheels with internal thread        | 179  |                                      |      |
| • Mounted flap wheels with threaded shank         | 180  |                                      |      |

### High Performance marking



*Ordering example:*

**Packing unit:**  
10 pcs. per type

The High Performance products are additionally marked on the table with the High Performance heading

*Further information on page 4.*

## Information

### **SFL, mounted flap wheels of abrasive cloth**

These tools consist of individual flaps radially located around the hub of the tool; they are mainly used in hand-held power tools.

We offer our coated abrasive flap wheels in various qualities i.e. NK, NKE and SIC.

#### **Examples of application:**

- finishing
- derusting
- fettling
- deburring
- surface grinding
- decorative finishing
- bevelling

### **SFB, Mounted flap wheels of abrasive cloth, slotted**

By slotting the lamellas on the periphery, the flexibility of this type of mounted flap wheel is increased. The slotted flap wheel quickly profiles itself to the contour of the workpiece.

### **SFT, Mounted flap wheels of abrasive cloth, recessed**

These tools are suitable for face and peripheral grinding.

### **Adaptor for SFI and SFA**

These adaptors extend the shank length and optimise down-time. Tool change is made without removing the adaptor from the machine.

## SFL, Flap wheels

Ordering example: A2200020103080

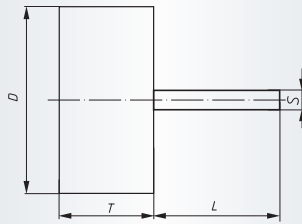
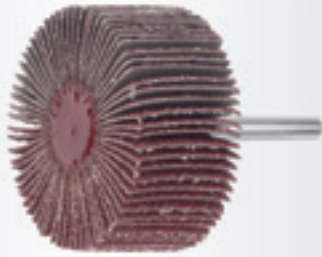

**Packing unit:**

10 pcs. per type

Further dimensions, qualities

and shank lengths on request

NK = reg. Aluminium Oxide

| Description  | Grits  | D mm | T mm | S mm | L mm | n recom. (1/min) | n max. (1/min) | Product-Number | recommended for |   |     |
|--------------|--------|------|------|------|------|------------------|----------------|----------------|-----------------|---|-----|
| SFL 01010.03 | NK 80  | 10   | 10   | 3    | 40   | 26.000           | 35.000         | A2200010103080 | 1 2 3 4 5 6 7 8 | ■ | NEW |
| SFL 01010.03 | NK 120 | 10   | 10   | 3    | 40   | 26.000           | 35.000         | A2200010103120 | 1 2 3 4 5 6 7 8 | ■ | NEW |
| SFL 01010.03 | NK 150 | 10   | 10   | 3    | 40   | 26.000           | 35.000         | A2200010103150 | 1 2 3 4 5 6 7 8 | ■ | NEW |
| SFL 01515.03 | NK 80  | 15   | 15   | 3    | 40   | 24.000           | 35.000         | A2200015153080 | 1 2 3 4 5 6 7 8 | ■ | NEW |
| SFL 01515.03 | NK 120 | 15   | 15   | 3    | 40   | 24.000           | 35.000         | A2200015153120 | 1 2 3 4 5 6 7 8 | ■ | NEW |
| SFL 01515.03 | NK 150 | 15   | 15   | 3    | 40   | 24.000           | 35.000         | A2200015153150 | 1 2 3 4 5 6 7 8 | ■ | NEW |
| SFL 02010.03 | NK 80  | 20   | 10   | 3    | 40   | 20.000           | 28.000         | A2200020103080 | 1 2 3 4 5 6 7 8 | ■ |     |
| SFL 02010.03 | NK 120 | 20   | 10   | 3    | 40   | 20.000           | 28.000         | A2200020103120 | 1 2 3 4 5 6 7 8 | ■ |     |
| SFL 02010.03 | NK 150 | 20   | 10   | 3    | 40   | 20.000           | 28.000         | A2200020103150 | 1 2 3 4 5 6 7 8 | ■ |     |
| SFL 02015.06 | NK 80  | 20   | 15   | 6    | 40   | 20.000           | 28.000         | A2200020156080 | 1 2 3 4 5 6 7 8 | ■ |     |
| SFL 02015.06 | NK 120 | 20   | 15   | 6    | 40   | 20.000           | 28.000         | A2200020156120 | 1 2 3 4 5 6 7 8 | ■ |     |
| SFL 02015.06 | NK 150 | 20   | 15   | 6    | 40   | 20.000           | 28.000         | A2200020156150 | 1 2 3 4 5 6 7 8 | ■ |     |
| SFL 02510.03 | NK 80  | 25   | 10   | 3    | 40   | 16.000           | 18.000         | A2200025103080 | 1 2 3 4 5 6 7 8 | ■ |     |
| SFL 02510.03 | NK 120 | 25   | 10   | 3    | 40   | 16.000           | 18.000         | A2200025103120 | 1 2 3 4 5 6 7 8 | ■ |     |
| SFL 02510.03 | NK 150 | 25   | 10   | 3    | 40   | 16.000           | 18.000         | A2200025103150 | 1 2 3 4 5 6 7 8 | ■ |     |
| SFL 02515.06 | NK 80  | 25   | 15   | 6    | 40   | 16.000           | 18.000         | A2200025156080 | 1 2 3 4 5 6 7 8 | ■ |     |
| SFL 02515.06 | NK 120 | 25   | 15   | 6    | 40   | 16.000           | 18.000         | A2200025156120 | 1 2 3 4 5 6 7 8 | ■ |     |
| SFL 02515.06 | NK 150 | 25   | 15   | 6    | 40   | 16.000           | 18.000         | A2200025156150 | 1 2 3 4 5 6 7 8 | ■ |     |
| SFL 03005.03 | NK 60  | 30   | 5    | 3    | 40   | 16.000           | 18.000         | A2200030053060 | 1 2 3 4 5 6 7 8 | ■ |     |
| SFL 03005.03 | NK 80  | 30   | 5    | 3    | 40   | 16.000           | 18.000         | A2200030053080 | 1 2 3 4 5 6 7 8 | ■ |     |
| SFL 03005.03 | NK 120 | 30   | 5    | 3    | 40   | 16.000           | 18.000         | A2200030053120 | 1 2 3 4 5 6 7 8 | ■ |     |
| SFL 03005.03 | NK 150 | 30   | 5    | 3    | 40   | 16.000           | 18.000         | A2200030053150 | 1 2 3 4 5 6 7 8 | ■ |     |
| SFL 03005.03 | NK 240 | 30   | 5    | 3    | 40   | 16.000           | 18.000         | A2200030053240 | 1 2 3 4 5 6 7 8 | ■ |     |
| SFL 03005.03 | NK 320 | 30   | 5    | 3    | 40   | 16.000           | 18.000         | A2200030053320 | 1 2 3 4 5 6 7 8 | ■ |     |
| SFL 03005.06 | NK 60  | 30   | 5    | 6    | 40   | 16.000           | 18.000         | A2200030056060 | 1 2 3 4 5 6 7 8 | ■ |     |
| SFL 03005.06 | NK 80  | 30   | 5    | 6    | 40   | 16.000           | 18.000         | A2200030056080 | 1 2 3 4 5 6 7 8 | ■ |     |
| SFL 03005.06 | NK 120 | 30   | 5    | 6    | 40   | 16.000           | 18.000         | A2200030056120 | 1 2 3 4 5 6 7 8 | ■ |     |
| SFL 03005.06 | NK 150 | 30   | 5    | 6    | 40   | 16.000           | 18.000         | A2200030056150 | 1 2 3 4 5 6 7 8 | ■ |     |
| SFL 03005.06 | NK 240 | 30   | 5    | 6    | 40   | 16.000           | 18.000         | A2200030056240 | 1 2 3 4 5 6 7 8 | ■ |     |
| SFL 03005.06 | NK 320 | 30   | 5    | 6    | 40   | 16.000           | 18.000         | A2200030056320 | 1 2 3 4 5 6 7 8 | ■ |     |
| SFL 03010.03 | NK 60  | 30   | 10   | 3    | 40   | 16.000           | 18.000         | A2200030103060 | 1 2 3 4 5 6 7 8 | ■ |     |
| SFL 03010.03 | NK 80  | 30   | 10   | 3    | 40   | 16.000           | 18.000         | A2200030103080 | 1 2 3 4 5 6 7 8 | ■ |     |
| SFL 03010.03 | NK 120 | 30   | 10   | 3    | 40   | 16.000           | 18.000         | A2200030103120 | 1 2 3 4 5 6 7 8 | ■ |     |
| SFL 03010.03 | NK 150 | 30   | 10   | 3    | 40   | 16.000           | 18.000         | A2200030103150 | 1 2 3 4 5 6 7 8 | ■ |     |

The stated maximum operating speed only applies to a maximum overhang  $L_0$  of 20 mm. Other overhang dimensions must be calculated separately.

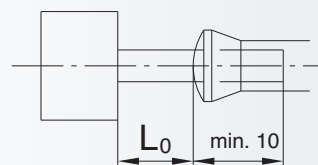

## SFL, Flap wheels

Ordering example: A2200030103240

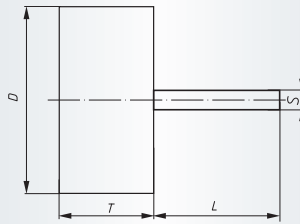
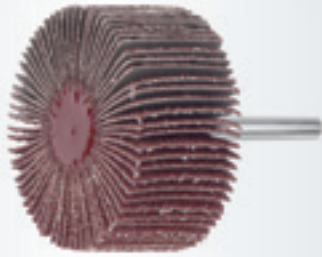

**Packing unit:**

10 pcs. per type

Further dimensions, qualities

and shank lengths on request

NK = reg. Aluminium Oxide

| Description  | Grits  | D mm | T mm | S mm | L mm | n recom. (1/min) | n max. (1/min) | Product-Number | recommended for |   |
|--------------|--------|------|------|------|------|------------------|----------------|----------------|-----------------|---|
| SFL 03010.03 | NK 240 | 30   | 10   | 3    | 40   | 16.000           | 18.000         | A2200030103240 | ① ② ③ ④ ⑤ ⑥ ⑦ ⑧ | ■ |
| SFL 03010.03 | NK 320 | 30   | 10   | 3    | 40   | 16.000           | 18.000         | A2200030103320 | ① ② ③ ④ ⑤ ⑥ ⑦ ⑧ | ■ |
| SFL 03010.06 | NK 60  | 30   | 10   | 6    | 40   | 16.000           | 18.000         | A2200030106060 | ① ② ③ ④ ⑤ ⑥ ⑦ ⑧ | ■ |
| SFL 03010.06 | NK 80  | 30   | 10   | 6    | 40   | 16.000           | 18.000         | A2200030106080 | ① ② ③ ④ ⑤ ⑥ ⑦ ⑧ | ■ |
| SFL 03010.06 | NK 120 | 30   | 10   | 6    | 40   | 16.000           | 18.000         | A2200030106120 | ① ② ③ ④ ⑤ ⑥ ⑦ ⑧ | ■ |
| SFL 03010.06 | NK 150 | 30   | 10   | 6    | 40   | 16.000           | 18.000         | A2200030106150 | ① ② ③ ④ ⑤ ⑥ ⑦ ⑧ | ■ |
| SFL 03010.06 | NK 240 | 30   | 10   | 6    | 40   | 16.000           | 18.000         | A2200030106240 | ① ② ③ ④ ⑤ ⑥ ⑦ ⑧ | ■ |
| SFL 03010.06 | NK 320 | 30   | 10   | 6    | 40   | 16.000           | 18.000         | A2200030106320 | ① ② ③ ④ ⑤ ⑥ ⑦ ⑧ | ■ |
| SFL 03015.06 | NK 60  | 30   | 15   | 6    | 40   | 16.000           | 18.000         | A2200030156060 | ① ② ③ ④ ⑤ ⑥ ⑦ ⑧ | ■ |
| SFL 03015.06 | NK 80  | 30   | 15   | 6    | 40   | 16.000           | 18.000         | A2200030156080 | ① ② ③ ④ ⑤ ⑥ ⑦ ⑧ | ■ |
| SFL 03015.06 | NK 120 | 30   | 15   | 6    | 40   | 16.000           | 18.000         | A2200030156120 | ① ② ③ ④ ⑤ ⑥ ⑦ ⑧ | ■ |
| SFL 03015.06 | NK 150 | 30   | 15   | 6    | 40   | 16.000           | 18.000         | A2200030156150 | ① ② ③ ④ ⑤ ⑥ ⑦ ⑧ | ■ |
| SFL 03020.06 | NK 40  | 30   | 20   | 6    | 40   | 16.000           | 18.000         | A2200030206040 | ① ② ③ ④ ⑤ ⑥ ⑦ ⑧ | ■ |
| SFL 03020.06 | NK 60  | 30   | 20   | 6    | 40   | 16.000           | 18.000         | A2200030206060 | ① ② ③ ④ ⑤ ⑥ ⑦ ⑧ | ■ |
| SFL 04010.03 | NK 60  | 40   | 10   | 3    | 40   | 12.000           | 18.000         | A2200040103060 | ① ② ③ ④ ⑤ ⑥ ⑦ ⑧ | ■ |
| SFL 04010.03 | NK 80  | 40   | 10   | 3    | 40   | 12.000           | 18.000         | A2200040103080 | ① ② ③ ④ ⑤ ⑥ ⑦ ⑧ | ■ |
| SFL 04010.03 | NK 120 | 40   | 10   | 3    | 40   | 12.000           | 18.000         | A2200040103120 | ① ② ③ ④ ⑤ ⑥ ⑦ ⑧ | ■ |
| SFL 04010.03 | NK 150 | 40   | 10   | 3    | 40   | 12.000           | 18.000         | A2200040103150 | ① ② ③ ④ ⑤ ⑥ ⑦ ⑧ | ■ |
| SFL 04010.06 | NK 60  | 40   | 10   | 6    | 40   | 12.000           | 18.000         | A2200040106060 | ① ② ③ ④ ⑤ ⑥ ⑦ ⑧ | ■ |
| SFL 04010.06 | NK 80  | 40   | 10   | 6    | 40   | 12.000           | 18.000         | A2200040106080 | ① ② ③ ④ ⑤ ⑥ ⑦ ⑧ | ■ |
| SFL 04010.06 | NK 120 | 40   | 10   | 6    | 40   | 12.000           | 18.000         | A2200040106120 | ① ② ③ ④ ⑤ ⑥ ⑦ ⑧ | ■ |
| SFL 04010.06 | NK 150 | 40   | 10   | 6    | 40   | 12.000           | 18.000         | A2200040106150 | ① ② ③ ④ ⑤ ⑥ ⑦ ⑧ | ■ |
| SFL 04010.06 | NK 240 | 40   | 10   | 6    | 40   | 12.000           | 18.000         | A2200040106240 | ① ② ③ ④ ⑤ ⑥ ⑦ ⑧ | ■ |
| SFL 04010.06 | NK 320 | 40   | 10   | 6    | 40   | 12.000           | 18.000         | A2200040106320 | ① ② ③ ④ ⑤ ⑥ ⑦ ⑧ | ■ |
| SFL 04015.06 | NK 40  | 40   | 15   | 6    | 40   | 12.000           | 18.000         | A2200040156040 | ① ② ③ ④ ⑤ ⑥ ⑦ ⑧ | ■ |
| SFL 04015.06 | NK 60  | 40   | 15   | 6    | 40   | 12.000           | 18.000         | A2200040156060 | ① ② ③ ④ ⑤ ⑥ ⑦ ⑧ | ■ |
| SFL 04015.06 | NK 80  | 40   | 15   | 6    | 40   | 12.000           | 18.000         | A2200040156080 | ① ② ③ ④ ⑤ ⑥ ⑦ ⑧ | ■ |
| SFL 04015.06 | NK 120 | 40   | 15   | 6    | 40   | 12.000           | 18.000         | A2200040156120 | ① ② ③ ④ ⑤ ⑥ ⑦ ⑧ | ■ |
| SFL 04015.06 | NK 150 | 40   | 15   | 6    | 40   | 12.000           | 18.000         | A2200040156150 | ① ② ③ ④ ⑤ ⑥ ⑦ ⑧ | ■ |
| SFL 04015.06 | NK 240 | 40   | 15   | 6    | 40   | 12.000           | 18.000         | A2200040156240 | ① ② ③ ④ ⑤ ⑥ ⑦ ⑧ | ■ |
| SFL 04015.06 | NK 320 | 40   | 15   | 6    | 40   | 12.000           | 18.000         | A2200040156320 | ① ② ③ ④ ⑤ ⑥ ⑦ ⑧ | ■ |
| SFL 04020.06 | NK 60  | 40   | 20   | 6    | 40   | 12.000           | 18.000         | A2200040206060 | ① ② ③ ④ ⑤ ⑥ ⑦ ⑧ | ■ |
| SFL 04020.06 | NK 80  | 40   | 20   | 6    | 40   | 12.000           | 18.000         | A2200040206080 | ① ② ③ ④ ⑤ ⑥ ⑦ ⑧ | ■ |
| SFL 04020.06 | NK 120 | 40   | 20   | 6    | 40   | 12.000           | 18.000         | A2200040206120 | ① ② ③ ④ ⑤ ⑥ ⑦ ⑧ | ■ |

The stated maximum operating speed only applies to a maximum overhang  $L_0$  of 20 mm. Other overhang dimensions must be calculated separately.

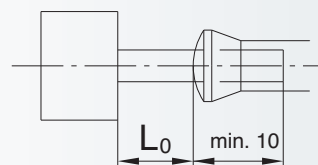

## SFL, Flap wheels

Ordering example: A2200040206150

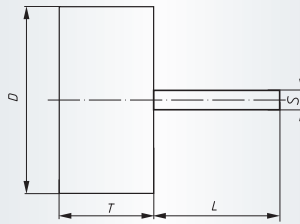
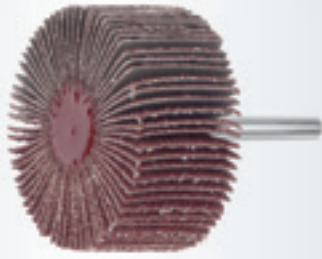

**Packing unit:**

10 pcs. per type

Further dimensions, qualities

and shank lengths on request

NK = reg. Aluminium Oxide

| Description  | Grits  | D mm | T mm | S mm | L mm | n recom. (1/min) | n max. (1/min) | Product-Number | recommended for |   |
|--------------|--------|------|------|------|------|------------------|----------------|----------------|-----------------|---|
| SFL 04020.06 | NK 150 | 40   | 20   | 6    | 40   | 12.000           | 18.000         | A2200040206150 | ① ② ③ ④ ⑤ ⑥ ⑦ ⑧ | ■ |
| SFL 04020.06 | NK 240 | 40   | 20   | 6    | 40   | 12.000           | 18.000         | A2200040206240 | ① ② ③ ④ ⑤ ⑥ ⑦ ⑧ | ■ |
| SFL 04020.06 | NK 320 | 40   | 20   | 6    | 40   | 12.000           | 18.000         | A2200040206320 | ① ② ③ ④ ⑤ ⑥ ⑦ ⑧ | ■ |
| SFL 05010.06 | NK 60  | 50   | 10   | 6    | 40   | 9.000            | 12.000         | A2200050106060 | ① ② ③ ④ ⑤ ⑥ ⑦ ⑧ | ■ |
| SFL 05010.06 | NK 80  | 50   | 10   | 6    | 40   | 9.000            | 12.000         | A2200050106080 | ① ② ③ ④ ⑤ ⑥ ⑦ ⑧ | ■ |
| SFL 05010.06 | NK 120 | 50   | 10   | 6    | 40   | 9.000            | 12.000         | A2200050106120 | ① ② ③ ④ ⑤ ⑥ ⑦ ⑧ | ■ |
| SFL 05010.06 | NK 150 | 50   | 10   | 6    | 40   | 9.000            | 12.000         | A2200050106150 | ① ② ③ ④ ⑤ ⑥ ⑦ ⑧ | ■ |
| SFL 05010.06 | NK 240 | 50   | 10   | 6    | 40   | 9.000            | 12.000         | A2200050106240 | ① ② ③ ④ ⑤ ⑥ ⑦ ⑧ | ■ |
| SFL 05015.06 | NK 40  | 50   | 15   | 6    | 40   | 9.000            | 12.000         | A2200050156040 | ① ② ③ ④ ⑤ ⑥ ⑦ ⑧ | ■ |
| SFL 05015.06 | NK 60  | 50   | 15   | 6    | 40   | 9.000            | 12.000         | A2200050156060 | ① ② ③ ④ ⑤ ⑥ ⑦ ⑧ | ■ |
| SFL 05015.06 | NK 80  | 50   | 15   | 6    | 40   | 9.000            | 12.000         | A2200050156080 | ① ② ③ ④ ⑤ ⑥ ⑦ ⑧ | ■ |
| SFL 05015.06 | NK 120 | 50   | 15   | 6    | 40   | 9.000            | 12.000         | A2200050156120 | ① ② ③ ④ ⑤ ⑥ ⑦ ⑧ | ■ |
| SFL 05015.06 | NK 150 | 50   | 15   | 6    | 40   | 9.000            | 12.000         | A2200050156150 | ① ② ③ ④ ⑤ ⑥ ⑦ ⑧ | ■ |
| SFL 05015.06 | NK 240 | 50   | 15   | 6    | 40   | 9.000            | 12.000         | A2200050156240 | ① ② ③ ④ ⑤ ⑥ ⑦ ⑧ | ■ |
| SFL 05015.06 | NK 320 | 50   | 15   | 6    | 40   | 9.000            | 12.000         | A2200050156320 | ① ② ③ ④ ⑤ ⑥ ⑦ ⑧ | ■ |
| SFL 05020.06 | NK 40  | 50   | 20   | 6    | 40   | 9.000            | 12.000         | A2200050206040 | ① ② ③ ④ ⑤ ⑥ ⑦ ⑧ | ■ |
| SFL 05020.06 | NK 60  | 50   | 20   | 6    | 40   | 9.000            | 12.000         | A2200050206060 | ① ② ③ ④ ⑤ ⑥ ⑦ ⑧ | ■ |
| SFL 05020.06 | NK 80  | 50   | 20   | 6    | 40   | 9.000            | 12.000         | A2200050206080 | ① ② ③ ④ ⑤ ⑥ ⑦ ⑧ | ■ |
| SFL 05020.06 | NK 120 | 50   | 20   | 6    | 40   | 9.000            | 12.000         | A2200050206120 | ① ② ③ ④ ⑤ ⑥ ⑦ ⑧ | ■ |
| SFL 05020.06 | NK 150 | 50   | 20   | 6    | 40   | 9.000            | 12.000         | A2200050206150 | ① ② ③ ④ ⑤ ⑥ ⑦ ⑧ | ■ |
| SFL 05020.06 | NK 240 | 50   | 20   | 6    | 40   | 9.000            | 12.000         | A2200050206240 | ① ② ③ ④ ⑤ ⑥ ⑦ ⑧ | ■ |
| SFL 05020.06 | NK 320 | 50   | 20   | 6    | 40   | 9.000            | 12.000         | A2200050206320 | ① ② ③ ④ ⑤ ⑥ ⑦ ⑧ | ■ |
| SFL 05030.06 | NK 60  | 50   | 20   | 6    | 40   | 9.000            | 12.000         | A2200050306060 | ① ② ③ ④ ⑤ ⑥ ⑦ ⑧ | ■ |
| SFL 05030.06 | NK 80  | 50   | 20   | 6    | 40   | 9.000            | 12.000         | A2200050306080 | ① ② ③ ④ ⑤ ⑥ ⑦ ⑧ | ■ |
| SFL 05030.06 | NK 120 | 50   | 20   | 6    | 40   | 9.000            | 12.000         | A2200050306120 | ① ② ③ ④ ⑤ ⑥ ⑦ ⑧ | ■ |
| SFL 05030.06 | NK 150 | 50   | 20   | 6    | 40   | 9.000            | 12.000         | A2200050306150 | ① ② ③ ④ ⑤ ⑥ ⑦ ⑧ | ■ |
| SFL 05030.06 | NK 320 | 50   | 20   | 6    | 40   | 9.000            | 12.000         | A2200050306320 | ① ② ③ ④ ⑤ ⑥ ⑦ ⑧ | ■ |
| SFL 06015.06 | NK 40  | 60   | 15   | 6    | 40   | 8.000            | 12.000         | A2200060156040 | ① ② ③ ④ ⑤ ⑥ ⑦ ⑧ | ■ |
| SFL 06015.06 | NK 60  | 60   | 15   | 6    | 40   | 8.000            | 12.000         | A2200060156060 | ① ② ③ ④ ⑤ ⑥ ⑦ ⑧ | ■ |
| SFL 06015.06 | NK 80  | 60   | 15   | 6    | 40   | 8.000            | 12.000         | A2200060156080 | ① ② ③ ④ ⑤ ⑥ ⑦ ⑧ | ■ |
| SFL 06015.06 | NK 120 | 60   | 15   | 6    | 40   | 8.000            | 12.000         | A2200060156120 | ① ② ③ ④ ⑤ ⑥ ⑦ ⑧ | ■ |
| SFL 06015.06 | NK 150 | 60   | 15   | 6    | 40   | 8.000            | 12.000         | A2200060156150 | ① ② ③ ④ ⑤ ⑥ ⑦ ⑧ | ■ |
| SFL 06015.06 | NK 240 | 60   | 15   | 6    | 40   | 8.000            | 12.000         | A2200060156240 | ① ② ③ ④ ⑤ ⑥ ⑦ ⑧ | ■ |
| SFL 06015.06 | NK 320 | 60   | 15   | 6    | 40   | 8.000            | 12.000         | A2200060156320 | ① ② ③ ④ ⑤ ⑥ ⑦ ⑧ | ■ |

The stated maximum operating speed only applies to a maximum overhang  $L_0$  of 20 mm. Other overhang dimensions must be calculated separately.

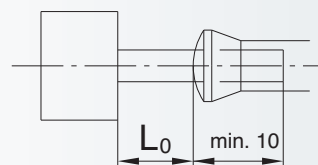

SFL, Flap wheels

Ordering example: A2200060206040

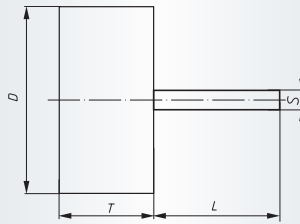
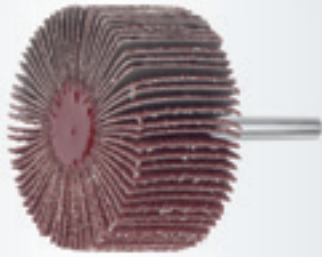

**Packing unit:**

10 pcs. per type

Further dimensions, qualities

and shank lengths on request

NK = reg. Aluminium Oxide

| Description  | Grits  | D mm | T mm | S mm | L mm | n recom. (1/min) | n max. (1/min) | Product-Number | recommended for |   |
|--------------|--------|------|------|------|------|------------------|----------------|----------------|-----------------|---|
| SFL 06020.06 | NK 40  | 60   | 20   | 6    | 40   | 8.000            | 12.000         | A2200060206040 | 1 2 3 4 5 6 7 8 | ■ |
| SFL 06020.06 | NK 60  | 60   | 20   | 6    | 40   | 8.000            | 12.000         | A2200060206060 | 1 2 3 4 5 6 7 8 | ■ |
| SFL 06020.06 | NK 80  | 60   | 20   | 6    | 40   | 8.000            | 12.000         | A2200060206080 | 1 2 3 4 5 6 7 8 | ■ |
| SFL 06020.06 | NK 120 | 60   | 20   | 6    | 40   | 8.000            | 12.000         | A2200060206120 | 1 2 3 4 5 6 7 8 | ■ |
| SFL 06020.06 | NK 150 | 60   | 20   | 6    | 40   | 8.000            | 12.000         | A2200060206150 | 1 2 3 4 5 6 7 8 | ■ |
| SFL 06020.06 | NK 240 | 60   | 20   | 6    | 40   | 8.000            | 12.000         | A2200060206240 | 1 2 3 4 5 6 7 8 | ■ |
| SFL 06020.06 | NK 320 | 60   | 20   | 6    | 40   | 8.000            | 12.000         | A2200060206320 | 1 2 3 4 5 6 7 8 | ■ |
| SFL 06030.06 | NK 40  | 60   | 30   | 6    | 40   | 8.000            | 12.000         | A2200060306040 | 1 2 3 4 5 6 7 8 | ■ |
| SFL 06030.06 | NK 60  | 60   | 30   | 6    | 40   | 8.000            | 12.000         | A2200060306060 | 1 2 3 4 5 6 7 8 | ■ |
| SFL 06030.06 | NK 80  | 60   | 30   | 6    | 40   | 8.000            | 12.000         | A2200060306080 | 1 2 3 4 5 6 7 8 | ■ |
| SFL 06030.06 | NK 120 | 60   | 30   | 6    | 40   | 8.000            | 12.000         | A2200060306120 | 1 2 3 4 5 6 7 8 | ■ |
| SFL 06030.06 | NK 150 | 60   | 30   | 6    | 40   | 8.000            | 12.000         | A2200060306150 | 1 2 3 4 5 6 7 8 | ■ |
| SFL 06030.06 | NK 240 | 60   | 30   | 6    | 40   | 8.000            | 12.000         | A2200060306240 | 1 2 3 4 5 6 7 8 | ■ |
| SFL 06030.06 | NK 320 | 60   | 30   | 6    | 40   | 8.000            | 12.000         | A2200060306320 | 1 2 3 4 5 6 7 8 | ■ |
| SFL 06040.06 | NK 40  | 60   | 40   | 6    | 40   | 8.000            | 12.000         | A2200060406040 | 1 2 3 4 5 6 7 8 | ■ |
| SFL 06040.06 | NK 60  | 60   | 40   | 6    | 40   | 8.000            | 12.000         | A2200060406060 | 1 2 3 4 5 6 7 8 | ■ |
| SFL 06040.06 | NK 80  | 60   | 40   | 6    | 40   | 8.000            | 12.000         | A2200060406080 | 1 2 3 4 5 6 7 8 | ■ |
| SFL 06040.06 | NK 120 | 60   | 40   | 6    | 40   | 8.000            | 12.000         | A2200060406120 | 1 2 3 4 5 6 7 8 | ■ |
| SFL 06040.06 | NK 150 | 60   | 40   | 6    | 40   | 8.000            | 12.000         | A2200060406150 | 1 2 3 4 5 6 7 8 | ■ |
| SFL 06040.06 | NK 240 | 60   | 40   | 6    | 40   | 8.000            | 12.000         | A2200060406240 | 1 2 3 4 5 6 7 8 | ■ |
| SFL 06040.06 | NK 320 | 60   | 40   | 6    | 40   | 8.000            | 12.000         | A2200060406320 | 1 2 3 4 5 6 7 8 | ■ |
| SFL 06050.06 | NK 60  | 60   | 50   | 6    | 40   | 8.000            | 8.500          | A2200060506060 | 1 2 3 4 5 6 7 8 | ■ |
| SFL 06050.06 | NK 80  | 60   | 50   | 6    | 40   | 8.000            | 8.500          | A2200060506080 | 1 2 3 4 5 6 7 8 | ■ |
| SFL 06050.06 | NK 120 | 60   | 50   | 6    | 40   | 8.000            | 8.500          | A2200060506120 | 1 2 3 4 5 6 7 8 | ■ |
| SFL 06050.06 | NK 150 | 60   | 50   | 6    | 40   | 8.000            | 8.500          | A2200060506150 | 1 2 3 4 5 6 7 8 | ■ |
| SFL 06050.06 | NK 240 | 60   | 50   | 6    | 40   | 8.000            | 8.500          | A2200060506240 | 1 2 3 4 5 6 7 8 | ■ |
| SFL 08015.06 | NK 60  | 80   | 15   | 6    | 40   | 6.000            | 9.000          | A2200080156060 | 1 2 3 4 5 6 7 8 | ■ |
| SFL 08015.06 | NK 80  | 80   | 15   | 6    | 40   | 6.000            | 9.000          | A2200080156080 | 1 2 3 4 5 6 7 8 | ■ |
| SFL 08015.06 | NK 120 | 80   | 15   | 6    | 40   | 6.000            | 9.000          | A2200080156120 | 1 2 3 4 5 6 7 8 | ■ |
| SFL 08015.06 | NK 150 | 80   | 15   | 6    | 40   | 6.000            | 9.000          | A2200080156150 | 1 2 3 4 5 6 7 8 | ■ |
| SFL 08015.06 | NK 240 | 80   | 15   | 6    | 40   | 6.000            | 9.000          | A2200080156240 | 1 2 3 4 5 6 7 8 | ■ |
| SFL 08015.06 | NK 320 | 80   | 15   | 6    | 40   | 6.000            | 9.000          | A2200080156320 | 1 2 3 4 5 6 7 8 | ■ |
| SFL 08020.06 | NK 60  | 80   | 20   | 6    | 40   | 6.000            | 9.000          | A2200080206060 | 1 2 3 4 5 6 7 8 | ■ |
| SFL 08020.06 | NK 80  | 80   | 20   | 6    | 40   | 6.000            | 9.000          | A2200080206080 | 1 2 3 4 5 6 7 8 | ■ |

The stated maximum operating speed only applies to a maximum overhang  $L_0$  of 20 mm. Other overhang dimensions must be calculated separately.

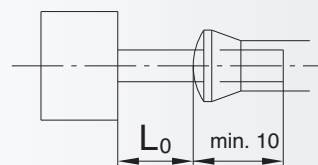

## SFL, Flap wheels

Ordering example: A2200080206120

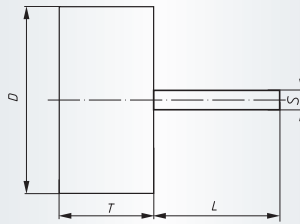
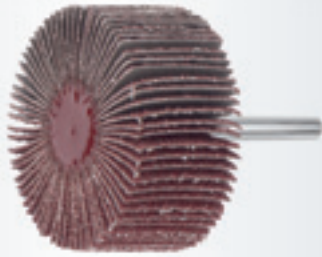

**Packing unit:**

10 pcs. per type

Further dimensions, qualities

and shank lengths on request

NK = reg. Aluminium Oxide

| Description  | Grits  | D mm | T mm | S mm | L mm | n recom. (1/min) | n max. (1/min) | Product-Number | recommended for |   |
|--------------|--------|------|------|------|------|------------------|----------------|----------------|-----------------|---|
| SFL 08020.06 | NK 120 | 80   | 20   | 6    | 40   | 6.000            | 9.000          | A2200080206120 | 1 2 3 4 5 6 7 8 | ■ |
| SFL 08020.06 | NK 150 | 80   | 20   | 6    | 40   | 6.000            | 9.000          | A2200080206150 | 1 2 3 4 5 6 7 8 | ■ |
| SFL 08020.06 | NK 240 | 80   | 20   | 6    | 40   | 6.000            | 9.000          | A2200080206240 | 1 2 3 4 5 6 7 8 | ■ |
| SFL 08020.06 | NK 320 | 80   | 20   | 6    | 40   | 6.000            | 9.000          | A2200080206320 | 1 2 3 4 5 6 7 8 | ■ |
| SFL 08030.06 | NK 40  | 80   | 30   | 6    | 40   | 6.000            | 9.000          | A2200080306040 | 1 2 3 4 5 6 7 8 | ■ |
| SFL 08030.06 | NK 60  | 80   | 30   | 6    | 40   | 6.000            | 9.000          | A2200080306060 | 1 2 3 4 5 6 7 8 | ■ |
| SFL 08030.06 | NK 80  | 80   | 30   | 6    | 40   | 6.000            | 9.000          | A2200080306080 | 1 2 3 4 5 6 7 8 | ■ |
| SFL 08030.06 | NK 120 | 80   | 30   | 6    | 40   | 6.000            | 9.000          | A2200080306120 | 1 2 3 4 5 6 7 8 | ■ |
| SFL 08030.06 | NK 150 | 80   | 30   | 6    | 40   | 6.000            | 9.000          | A2200080306150 | 1 2 3 4 5 6 7 8 | ■ |
| SFL 08030.06 | NK 320 | 80   | 30   | 6    | 40   | 6.000            | 9.000          | A2200080306320 | 1 2 3 4 5 6 7 8 | ■ |
| SFL 08040.06 | NK 60  | 80   | 40   | 6    | 40   | 6.000            | 9.000          | A2200080406060 | 1 2 3 4 5 6 7 8 | ■ |
| SFL 08040.06 | NK 80  | 80   | 40   | 6    | 40   | 6.000            | 9.000          | A2200080406080 | 1 2 3 4 5 6 7 8 | ■ |
| SFL 08040.06 | NK 150 | 80   | 40   | 6    | 40   | 6.000            | 9.000          | A2200080406150 | 1 2 3 4 5 6 7 8 | ■ |
| SFL 08040.06 | NK 240 | 80   | 40   | 6    | 40   | 6.000            | 9.000          | A2200080406240 | 1 2 3 4 5 6 7 8 | ■ |
| SFL 08050.06 | NK 40  | 80   | 50   | 6    | 40   | 6.000            | 7.500          | A2200080506040 | 1 2 3 4 5 6 7 8 | ■ |
| SFL 08050.06 | NK 60  | 80   | 50   | 6    | 40   | 6.000            | 7.500          | A2200080506060 | 1 2 3 4 5 6 7 8 | ■ |
| SFL 08050.06 | NK 80  | 80   | 50   | 6    | 40   | 6.000            | 7.500          | A2200080506080 | 1 2 3 4 5 6 7 8 | ■ |
| SFL 08050.06 | NK 120 | 80   | 50   | 6    | 40   | 6.000            | 7.500          | A2200080506120 | 1 2 3 4 5 6 7 8 | ■ |
| SFL 08050.06 | NK 150 | 80   | 50   | 6    | 40   | 6.000            | 7.500          | A2200080506150 | 1 2 3 4 5 6 7 8 | ■ |
| SFL 08050.06 | NK 240 | 80   | 50   | 6    | 40   | 6.000            | 7.500          | A2200080506240 | 1 2 3 4 5 6 7 8 | ■ |
| SFL 08050.06 | NK 320 | 80   | 50   | 6    | 40   | 6.000            | 7.500          | A2200080506320 | 1 2 3 4 5 6 7 8 | ■ |
| SFL 10040.08 | NK 40  | 100  | 40   | 8    | 40   | 5.000            | 7.500          | A2200100408040 | 1 2 3 4 5 6 7 8 | ■ |
| SFL 10040.08 | NK 60  | 100  | 40   | 8    | 40   | 5.000            | 7.500          | A2200100408060 | 1 2 3 4 5 6 7 8 | ■ |
| SFL 10050.08 | NK 60  | 100  | 50   | 8    | 40   | 5.000            | 7.500          | A2200100508060 | 1 2 3 4 5 6 7 8 | ■ |
| SFL 10050.08 | NK 80  | 100  | 50   | 8    | 40   | 5.000            | 7.500          | A2200100508080 | 1 2 3 4 5 6 7 8 | ■ |
| SFL 10050.08 | NK 150 | 100  | 50   | 8    | 40   | 5.000            | 7.500          | A2200100508150 | 1 2 3 4 5 6 7 8 | ■ |

The stated maximum operating speed only applies to a maximum overhang  $L_0$  of 20 mm. Other overhang dimensions must be calculated separately.

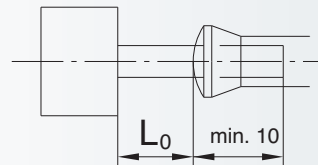

**SFB, Slotted flap wheel**

Ordering example: A2220040206080

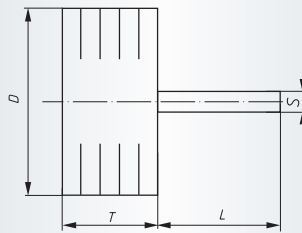

**Packing unit:**  
10 pcs. per type  
Further dimensions, qualities  
and shank lengths on request  
NK = reg. Aluminium Oxide

| Description  | Grits  | D mm | T mm | S mm | L mm | n recom. (1/min) | n max. (1/min) | Product-Number | recommended for |   |
|--------------|--------|------|------|------|------|------------------|----------------|----------------|-----------------|---|
| SFB 04020.06 | NK 80  | 40   | 20   | 6    | 40   | 12.000           | 18.000         | A2220040206080 | ① ② ③ ④ ⑤ ⑥ ⑦ ⑧ | ■ |
| SFB 05020.06 | NK 80  | 50   | 20   | 6    | 40   | 9.000            | 12.000         | A2220050206080 | ① ② ③ ④ ⑤ ⑥ ⑦ ⑧ | ■ |
| SFB 05030.06 | NK 120 | 50   | 30   | 6    | 40   | 9.000            | 12.000         | A2220050306120 | ① ② ③ ④ ⑤ ⑥ ⑦ ⑧ | ■ |
| SFB 06030.06 | NK 80  | 60   | 30   | 6    | 40   | 8.000            | 12.000         | A2220060306080 | ① ② ③ ④ ⑤ ⑥ ⑦ ⑧ | ■ |
| SFB 06030.06 | NK 120 | 60   | 30   | 6    | 40   | 8.000            | 12.000         | A2220060306120 | ① ② ③ ④ ⑤ ⑥ ⑦ ⑧ | ■ |

By slotting the lamellas on the periphery, the flexibility of this type of mounted wheel is increased. The slotted flap wheel quickly profiles itself to the contour of the workpiece. For special dimensions and grit sizes minimum quantity on request.

The stated maximum operating speed only applies to a maximum overhang  $L_0$  of 20 mm. Other overhang dimensions must be calculated separately.

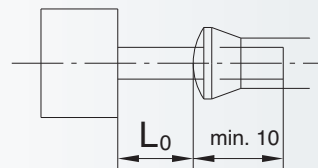

**SFT, Flap wheels – recessed**

Ordering example: A3100040306060

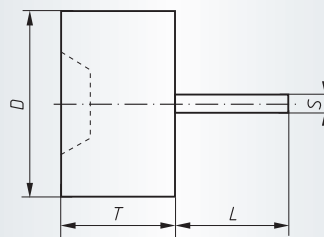
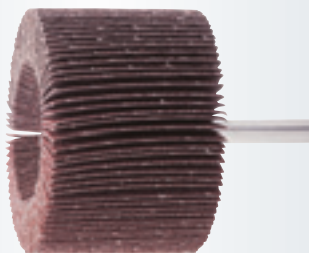

**Packing unit:**  
10 pcs. per type  
Further dimensions, qualities  
and shank lengths on request  
NK = reg. Aluminium Oxide

| Description  | Grits  | D mm | T mm | S mm | L mm | n recom. (1/min) | n max. (1/min) | Product-Number | recommended for |   |
|--------------|--------|------|------|------|------|------------------|----------------|----------------|-----------------|---|
| SFT 04030.06 | NK 60  | 40   | 30   | 6    | 40   | 12.000           | 18.000         | A3100040306060 | ① ② ③ ④ ⑤ ⑥ ⑦ ⑧ | ■ |
| SFT 04030.06 | NK 80  | 40   | 30   | 6    | 40   | 12.000           | 18.000         | A3100040306080 | ① ② ③ ④ ⑤ ⑥ ⑦ ⑧ | ■ |
| SFT 04030.06 | NK 150 | 40   | 30   | 6    | 40   | 12.000           | 18.000         | A3100040306150 | ① ② ③ ④ ⑤ ⑥ ⑦ ⑧ | ■ |
| SFT 06040.06 | NK 60  | 60   | 40   | 6    | 40   | 8.000            | 8.500          | A3100060406060 | ① ② ③ ④ ⑤ ⑥ ⑦ ⑧ | ■ |
| SFT 06040.06 | NK 80  | 60   | 40   | 6    | 40   | 8.000            | 8.500          | A3100060406080 | ① ② ③ ④ ⑤ ⑥ ⑦ ⑧ | ■ |
| SFT 06040.06 | NK 150 | 60   | 40   | 6    | 40   | 8.000            | 8.500          | A3100060406150 | ① ② ③ ④ ⑤ ⑥ ⑦ ⑧ | ■ |

The stated maximum operating speed only applies to a maximum overhang  $L_0$  of 20 mm. Other overhang dimensions must be calculated separately.

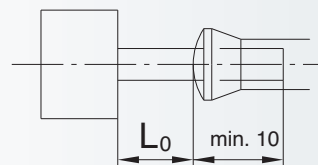



## SFE, Flap wheels of abrasive cloth, regular aluminium oxide, special bond

Ordering example: A2201030103120

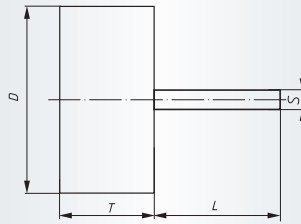
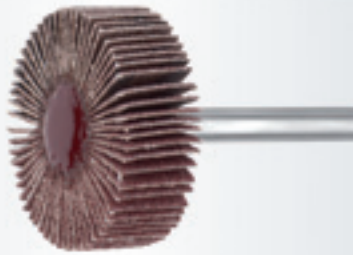

**Packing unit:**

10 pcs. per type

Further dimensions, qualities and shank lengths on request

NKE = reg. Aluminium Oxide with a coating of active grinding additives

| Description  | Grits   | D mm | T mm | S mm | L mm | n recom. (1/min) | n max. (1/min) | Product-Number | recommended for |   |
|--------------|---------|------|------|------|------|------------------|----------------|----------------|-----------------|---|
| SFE 03010.03 | NKE 120 | 30   | 10   | 3    | 40   | 16.000           | 18.000         | A2201030103120 | ① ② ③ ④ ⑤ ⑥ ⑦ ⑧ | ■ |
| SFE 03010.06 | NKE 60  | 30   | 10   | 6    | 40   | 16.000           | 18.000         | A2201030106060 | ① ② ③ ④ ⑤ ⑥ ⑦ ⑧ | ■ |
| SFE 03010.06 | NKE 80  | 30   | 10   | 6    | 40   | 16.000           | 18.000         | A2201030106080 | ① ② ③ ④ ⑤ ⑥ ⑦ ⑧ | ■ |
| SFE 03010.06 | NKE 150 | 30   | 10   | 6    | 40   | 16.000           | 18.000         | A2201030106150 | ① ② ③ ④ ⑤ ⑥ ⑦ ⑧ | ■ |
| SFE 04015.06 | NKE 60  | 40   | 15   | 6    | 40   | 12.000           | 18.000         | A2201040156060 | ① ② ③ ④ ⑤ ⑥ ⑦ ⑧ | ■ |
| SFE 04015.06 | NKE 80  | 40   | 15   | 6    | 40   | 12.000           | 18.000         | A2201040156080 | ① ② ③ ④ ⑤ ⑥ ⑦ ⑧ | ■ |
| SFE 04015.06 | NKE 120 | 40   | 15   | 6    | 40   | 12.000           | 18.000         | A2201040156120 | ① ② ③ ④ ⑤ ⑥ ⑦ ⑧ | ■ |
| SFE 05015.06 | NKE 80  | 50   | 15   | 6    | 40   | 9.000            | 12.000         | A2201050156080 | ① ② ③ ④ ⑤ ⑥ ⑦ ⑧ | ■ |
| SFE 05015.06 | NKE 150 | 50   | 15   | 6    | 40   | 9.000            | 12.000         | A2201050156150 | ① ② ③ ④ ⑤ ⑥ ⑦ ⑧ | ■ |
| SFE 06020.06 | NKE 80  | 60   | 20   | 6    | 40   | 8.000            | 12.000         | A2201060206080 | ① ② ③ ④ ⑤ ⑥ ⑦ ⑧ | ■ |
| SFE 06030.06 | NKE 60  | 60   | 30   | 6    | 40   | 8.000            | 12.000         | A2201060306060 | ① ② ③ ④ ⑤ ⑥ ⑦ ⑧ | ■ |
| SFE 06030.06 | NKE 80  | 60   | 30   | 6    | 40   | 8.000            | 12.000         | A2201060306080 | ① ② ③ ④ ⑤ ⑥ ⑦ ⑧ | ■ |
| SFE 06030.06 | NKE 120 | 60   | 30   | 6    | 40   | 8.000            | 12.000         | A2201060306120 | ① ② ③ ④ ⑤ ⑥ ⑦ ⑧ | ■ |
| SFE 06030.06 | NKE 150 | 60   | 30   | 6    | 40   | 8.000            | 12.000         | A2201060306150 | ① ② ③ ④ ⑤ ⑥ ⑦ ⑧ | ■ |
| SFE 06050.06 | NKE 60  | 60   | 50   | 6    | 40   | 8.000            | 8.500          | A2201060506060 | ① ② ③ ④ ⑤ ⑥ ⑦ ⑧ | ■ |
| SFE 06050.06 | NKE 120 | 60   | 50   | 6    | 40   | 8.000            | 8.500          | A2201060506120 | ① ② ③ ④ ⑤ ⑥ ⑦ ⑧ | ■ |
| SFE 08030.06 | NKE 80  | 80   | 30   | 6    | 40   | 6.000            | 9.000          | A2201080306080 | ① ② ③ ④ ⑤ ⑥ ⑦ ⑧ | ■ |
| SFE 08050.06 | NKE 80  | 80   | 50   | 6    | 40   | 6.000            | 7.500          | A2201080506080 | ① ② ③ ④ ⑤ ⑥ ⑦ ⑧ | ■ |

The stated maximum operating speed only applies to a maximum overhang  $L_0$  of 20 mm. Other overhang dimensions must be calculated separately.

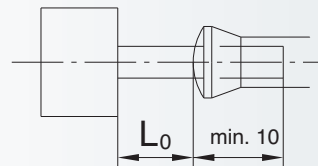

**SFC, Flap wheels of abrasive cloth, silicon carbide** Ordering example: A2202030106080

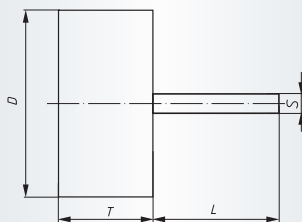

**Packing unit:**  
10 pcs. per type  
Further dimensions, qualities  
and shank lengths on request  
SIC = silicon carbide

| Description  | Grits   | D mm | T mm | S mm | L mm | n recom. (1/min) | n max. (1/min) | Product-Number | recommended for   |   |
|--------------|---------|------|------|------|------|------------------|----------------|----------------|-------------------|---|
| SFC 03010.06 | SIC 80  | 30   | 10   | 6    | 40   | 16.000           | 18.000         | A2202030106080 | ① ② ③ ④ ⑤ ⑥ ⑦ ⑧ ⑨ | ■ |
| SFC 03010.06 | SIC 150 | 30   | 10   | 6    | 40   | 16.000           | 18.000         | A2202030106150 | ① ② ③ ④ ⑤ ⑥ ⑦ ⑧ ⑨ | ■ |
| SFC 04015.06 | SIC 80  | 40   | 15   | 6    | 40   | 12.000           | 18.000         | A2202040156080 | ① ② ③ ④ ⑤ ⑥ ⑦ ⑧ ⑨ | ■ |
| SFC 06020.06 | SIC 80  | 60   | 20   | 6    | 40   | 8.000            | 12.000         | A2202060206080 | ① ② ③ ④ ⑤ ⑥ ⑦ ⑧ ⑨ | ■ |
| SFC 06020.06 | SIC 120 | 60   | 20   | 6    | 40   | 8.000            | 12.000         | A2202060206120 | ① ② ③ ④ ⑤ ⑥ ⑦ ⑧ ⑨ | ■ |
| SFC 06030.06 | SIC 120 | 60   | 30   | 6    | 40   | 8.000            | 12.000         | A2202060306120 | ① ② ③ ④ ⑤ ⑥ ⑦ ⑧ ⑨ | ■ |

The stated maximum operating speed only applies to a maximum overhang  $L_0$  of 20 mm. Other overhang dimensions must be calculated separately.

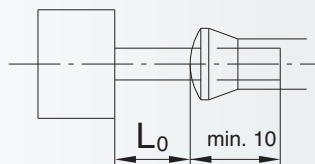

## SFI, Mounted flap wheels of abrasive cloth, with internal thread

Ordering example: A2207030050120

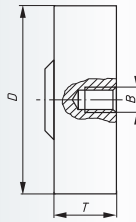
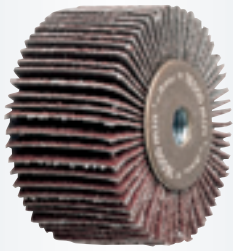

**Packing unit:**

10 pcs. per type

Further dimensions and qualities on request.

NK = reg. Aluminium Oxide

| Description  | Grits  | D mm | T mm | Thread B | n recom. (1/min) | n max. (1/min) | suitable tool adaptor | Product-Number | recommended for |   |
|--------------|--------|------|------|----------|------------------|----------------|-----------------------|----------------|-----------------|---|
| SFI 03005.M4 | NK 120 | 30   | 5    | M4       | 16.000           | 18.000         | WADI 0404             | A2207030050120 | ① ② ③ ④ ⑤ ⑥ ⑦ ⑧ | ■ |
| SFI 03005.M4 | NK 150 | 30   | 5    | M4       | 16.000           | 18.000         | WADI 0404             | A2207030050150 | ① ② ③ ④ ⑤ ⑥ ⑦ ⑧ | ■ |
| SFI 03010.M4 | NK 120 | 30   | 10   | M4       | 16.000           | 18.000         | WADI 0407             | A2207030100120 | ① ② ③ ④ ⑤ ⑥ ⑦ ⑧ | ■ |
| SFI 03010.M4 | NK 150 | 30   | 10   | M4       | 16.000           | 18.000         | WADI 0407             | A2207030100150 | ① ② ③ ④ ⑤ ⑥ ⑦ ⑧ | ■ |
| SFI 04015.M6 | NK 80  | 40   | 15   | M6       | 10.000           | 10.000         | WADI 0609             | A2207040150080 | ① ② ③ ④ ⑤ ⑥ ⑦ ⑧ | ■ |
| SFI 04015.M6 | NK 120 | 40   | 15   | M6       | 10.000           | 10.000         | WADI 0609             | A2207040150120 | ① ② ③ ④ ⑤ ⑥ ⑦ ⑧ | ■ |
| SFI 05020.M6 | NK 80  | 50   | 20   | M6       | 7.500            | 7.500          | WADI 0612             | A2207050200080 | ① ② ③ ④ ⑤ ⑥ ⑦ ⑧ | ■ |
| SFI 05020.M6 | NK 120 | 50   | 20   | M6       | 7.500            | 7.500          | WADI 0612             | A2207050200120 | ① ② ③ ④ ⑤ ⑥ ⑦ ⑧ | ■ |

The stated maximum permissible operating speed is only valid if the correct tool adaptor is used (see table).



## Adaptor for SFI

Ordering example: A36300404

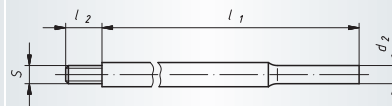
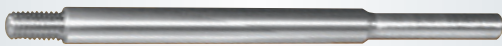

**Packing unit:**

1 pc. per type

| Description | d <sub>2</sub> mm | l <sub>1</sub> mm | S mm | l <sub>2</sub> mm | Product-Number | recommended for |   |
|-------------|-------------------|-------------------|------|-------------------|----------------|-----------------|---|
| WADI 0404   | 6                 | 80                | M4   | 4                 | A36300404      |                 | ■ |
| WADI 0407   | 6                 | 80                | M4   | 7                 | A36300407      |                 | ■ |
| WADI 0609   | 6                 | 100               | M6   | 9                 | A36300609      |                 | ■ |
| WADI 0612   | 6                 | 100               | M6   | 12                | A36300612      |                 | ■ |

SFA, Flap wheels of abrasive cloth, with external thread

Ordering example: A2200015055150

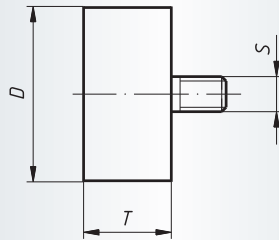

**Packing unit:**  
10 pcs. per type  
Further dimensions and qualities on request.  
NK = reg. Aluminium Oxide

| Description  | Grits  | D mm | T mm | Thread S | n recom. (1/min) | n max. (1/min) | Product-Number | recommended for |   |
|--------------|--------|------|------|----------|------------------|----------------|----------------|-----------------|---|
| SFA 01505.M5 | NK 150 | 15   | 5    | M5       | 16.000           | 18.000         | A2200015055150 | ① ② ③ ④ ⑤ ⑥ ⑦ ⑧ | ■ |
| SFA 01505.M5 | NK 240 | 15   | 5    | M5       | 16.000           | 18.000         | A2200015055240 | ① ② ③ ④ ⑤ ⑥ ⑦ ⑧ | ■ |
| SFA 02005.M5 | NK 150 | 20   | 5    | M5       | 16.000           | 18.000         | A2200020055150 | ① ② ③ ④ ⑤ ⑥ ⑦ ⑧ | ■ |
| SFA 02005.M5 | NK 240 | 20   | 5    | M5       | 16.000           | 18.000         | A2200020055240 | ① ② ③ ④ ⑤ ⑥ ⑦ ⑧ | ■ |
| SFA 03005.M5 | NK 120 | 30   | 5    | M5       | 16.000           | 18.000         | A2200030055120 | ① ② ③ ④ ⑤ ⑥ ⑦ ⑧ | ■ |
| SFA 03005.M5 | NK 150 | 30   | 5    | M5       | 16.000           | 18.000         | A2200030055150 | ① ② ③ ④ ⑤ ⑥ ⑦ ⑧ | ■ |
| SFA 03005.M5 | NK 240 | 30   | 5    | M5       | 16.000           | 18.000         | A2200030055240 | ① ② ③ ④ ⑤ ⑥ ⑦ ⑧ | ■ |

The stated maximum permissible operating speed is only valid if the correct tool adaptor is used (see table).

Adaptor for SFA

Ordering example: A36300518

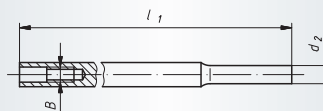
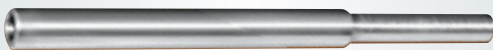

**Packing unit:**  
1 pc. per type

| Description | d2 mm | l1 mm | B mm | Product-Number | recommended for |   |
|-------------|-------|-------|------|----------------|-----------------|---|
| WADA 05     | 6     | 100   | M5   | A36300518      |                 | ■ |

**MFS, Mini-Flap wheels of abrasive cloth**

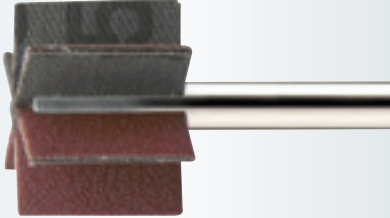

**Applications:**

- Production and cleaning of moulds for glass-industry
- Inside processing/machining of tubes
- Processing of light alloy rims
- Processing of the borings of turbine blades
- Manifold special applications

**Advantages:**

- Possibility of fine-grinding and finishing work
- The arrangement of the lamellars ensure high flexibility
- Good circulation of air and though cold grinding
- Processing of small borings and inner-diameters of tubes

Mini-Flap wheels with a diameter of 10–30 mm are available with different shank lengths and qualities.

available on request

**NEW**

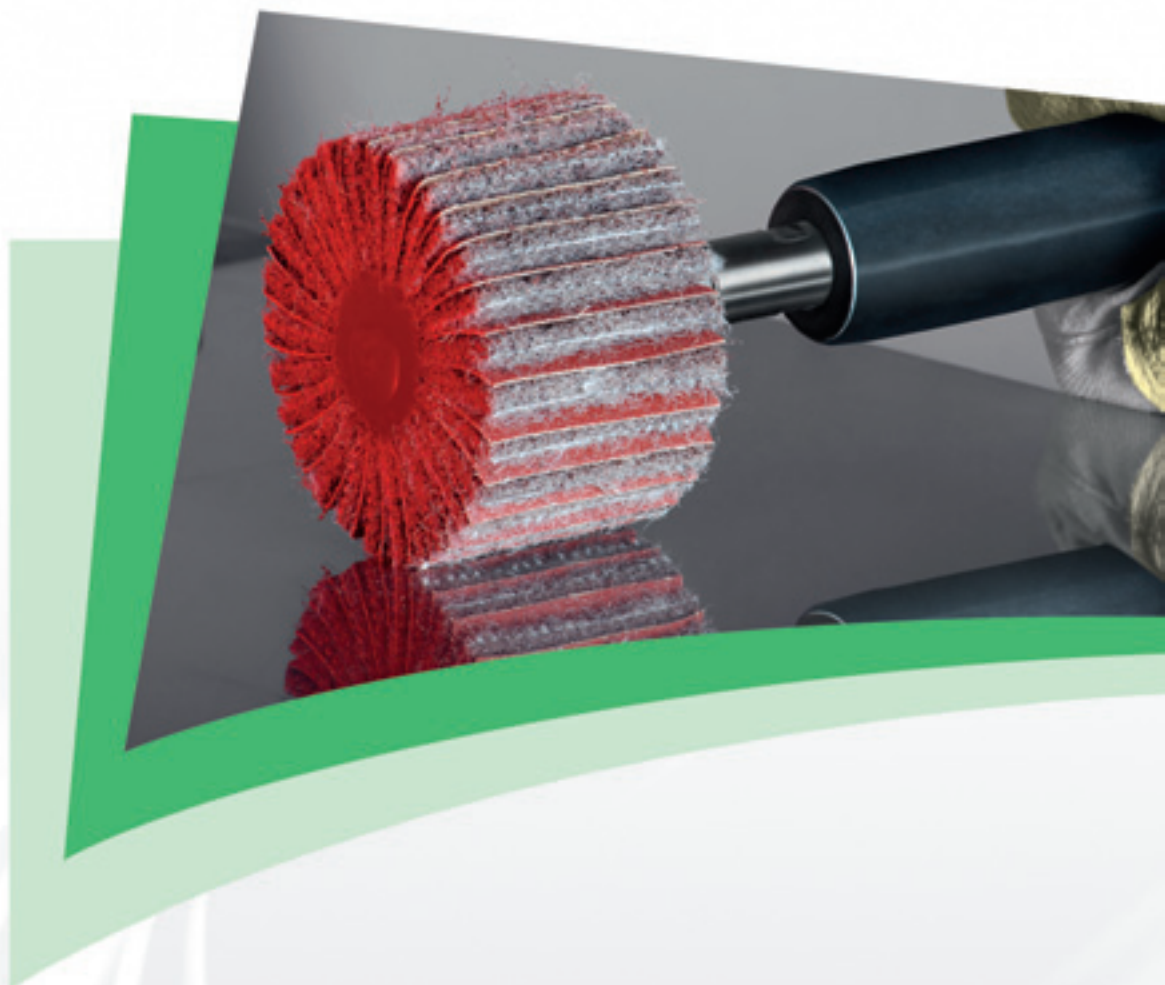

## Content

| Description   | Page |
|---|------|
| • Qualities and Applications  | 150  |
| • General Information   | 183  |
| • Mounted flap wheels abrasive fleece lamellar inserts              | 184  |
| • Mounted flap wheels abrasive fleece disc inserts                  | 186  |
| • Mounted flap wheels of abrasive fleece/abrasive cloth combination | 187  |
| • Power tool  | 271  |

## High Performance marking

### High Performance

Ordering example: A2204040206120

**Packing unit:**  
10 pcs. per type

The High Performance products are additionally marked on the table with the High Performance heading

Further information on page 4.

## Information

### **SFV, Flap wheels of fleece flaps**

These tools consist of individual flaps radially located around the hub of the tool; they are available in regular aluminium oxide (A) and Silicon carbide (C). SFV are mainly used in hand-held power tools.

#### **Examples of application:**

- matting
- conditioning
- polishing
- finishing
- fine surface finishing

### **SFR, Mounted fleece discs**

These special tools are produced by layering individual flexible round fleece sections. They are therefore ideally suited to the machining of profiles.

### **SFM, Flap wheels of abrasive fleece with abrasive cloth**

These tools consist of individual flaps of fleece and coated abrasive radially located around the hub of the tool; they are available in regular aluminium oxide (A) and silicon carbide (C)

The combination of coated abrasive and abrasive fleece allows for a greater stock removal compared to the SFV product type. SFM are mainly used in hand-held power tools.

#### **Examples of application:**

- preparation work
- de-rusting
- pre-finishing
- graining
- keying

### **SFM, spindle mounted flap wheels with TF-material**

These tools are particularly suited to stainless steel applications. The reverse side of the reinforced abrasive fleece guarantees uniform wear of the fleece and the coated abrasive flaps. Please take note of the rotational direction!

## SFV, Flap wheels of fleece flaps

Ordering example: A2203040206104

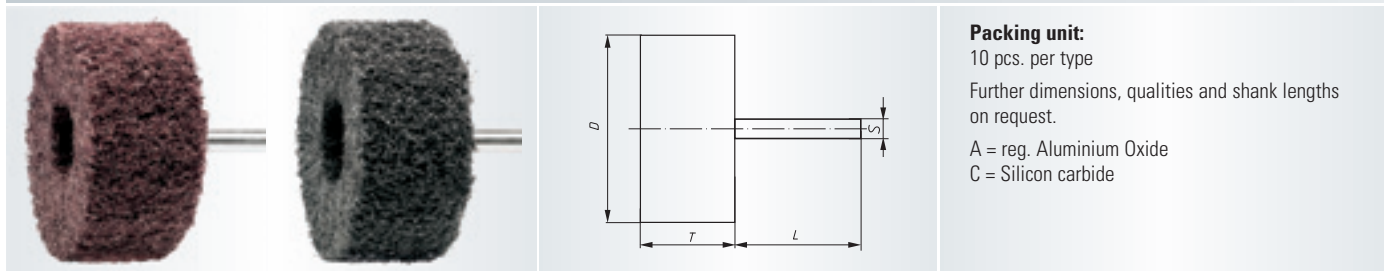

**Packing unit:**

10 pcs. per type

Further dimensions, qualities and shank lengths on request.

A = reg. Aluminium Oxide  
C = Silicon carbide

| Description  | Grits | D mm | T mm | S mm | L mm | n recom. (1/min) | n max. (1/min) | Product-Number | recommended for   |   |
|--------------|-------|------|------|------|------|------------------|----------------|----------------|-------------------|---|
| SFV 04020.06 | A 104 | 40   | 20   | 6    | 40   | 7.500            | 14.000         | A2203040206104 | ① ② ③ ④ ⑤ ⑥ ⑦ ⑧   | ■ |
| SFV 04020.06 | A 106 | 40   | 20   | 6    | 40   | 7.500            | 14.000         | A2203040206106 | ① ② ③ ④ ⑤ ⑥ ⑦ ⑧   | ■ |
| SFV 04020.06 | A 107 | 40   | 20   | 6    | 40   | 7.500            | 14.000         | A2203040206107 | ① ② ③ ④ ⑤ ⑥ ⑦ ⑧   | ■ |
| SFV 04020.06 | C 207 | 40   | 20   | 6    | 40   | 7.500            | 14.000         | A2203040206207 | ① ② ③ ④ ⑤ ⑥ ⑦ ⑧ ⑨ | ■ |
| SFV 04020.06 | C 206 | 40   | 20   | 6    | 40   | 7.500            | 14.000         | A2203040206206 | ① ② ③ ④ ⑤ ⑥ ⑦ ⑧ ⑨ | ■ |
| SFV 04030.06 | A 104 | 40   | 30   | 6    | 40   | 7.500            | 14.000         | A2203040306104 | ① ② ③ ④ ⑤ ⑥ ⑦ ⑧   | ■ |
| SFV 04030.06 | A 106 | 40   | 30   | 6    | 40   | 7.500            | 14.000         | A2203040306106 | ① ② ③ ④ ⑤ ⑥ ⑦ ⑧   | ■ |
| SFV 04030.06 | A 107 | 40   | 30   | 6    | 40   | 7.500            | 14.000         | A2203040306107 | ① ② ③ ④ ⑤ ⑥ ⑦ ⑧   | ■ |
| SFV 04030.06 | C 207 | 40   | 30   | 6    | 40   | 7.500            | 14.000         | A2203040306207 | ① ② ③ ④ ⑤ ⑥ ⑦ ⑧ ⑨ | ■ |
| SFV 05020.06 | A 104 | 50   | 20   | 6    | 40   | 6.000            | 11.000         | A2203050206104 | ① ② ③ ④ ⑤ ⑥ ⑦ ⑧   | ■ |
| SFV 05020.06 | A 106 | 50   | 20   | 6    | 40   | 6.000            | 11.000         | A2203050206106 | ① ② ③ ④ ⑤ ⑥ ⑦ ⑧   | ■ |
| SFV 05020.06 | C 204 | 50   | 20   | 6    | 40   | 6.000            | 11.000         | A2203050206204 | ① ② ③ ④ ⑤ ⑥ ⑦ ⑧ ⑨ | ■ |
| SFV 05020.06 | C 206 | 50   | 20   | 6    | 40   | 6.000            | 11.000         | A2203050206206 | ① ② ③ ④ ⑤ ⑥ ⑦ ⑧ ⑨ | ■ |
| SFV 05020.06 | C 207 | 50   | 20   | 6    | 40   | 6.000            | 11.000         | A2203050206207 | ① ② ③ ④ ⑤ ⑥ ⑦ ⑧ ⑨ | ■ |
| SFV 05030.06 | A 104 | 50   | 30   | 6    | 40   | 6.000            | 11.000         | A2203050306104 | ① ② ③ ④ ⑤ ⑥ ⑦ ⑧   | ■ |
| SFV 05030.06 | A 106 | 50   | 30   | 6    | 40   | 6.000            | 11.000         | A2203050306106 | ① ② ③ ④ ⑤ ⑥ ⑦ ⑧   | ■ |
| SFV 05030.06 | A 107 | 50   | 30   | 6    | 40   | 6.000            | 11.000         | A2203050306107 | ① ② ③ ④ ⑤ ⑥ ⑦ ⑧   | ■ |
| SFV 05030.06 | C 207 | 50   | 30   | 6    | 40   | 6.000            | 11.000         | A2203050306207 | ① ② ③ ④ ⑤ ⑥ ⑦ ⑧ ⑨ | ■ |
| SFV 05040.06 | A 104 | 50   | 40   | 6    | 40   | 6.000            | 11.000         | A2203050406104 | ① ② ③ ④ ⑤ ⑥ ⑦ ⑧   | ■ |
| SFV 05040.06 | A 106 | 50   | 40   | 6    | 40   | 6.000            | 11.000         | A2203050406106 | ① ② ③ ④ ⑤ ⑥ ⑦ ⑧   | ■ |
| SFV 05040.06 | A 107 | 50   | 40   | 6    | 40   | 6.000            | 11.000         | A2203050406107 | ① ② ③ ④ ⑤ ⑥ ⑦ ⑧   | ■ |
| SFV 05040.06 | C 207 | 50   | 40   | 6    | 40   | 6.000            | 11.000         | A2203050406207 | ① ② ③ ④ ⑤ ⑥ ⑦ ⑧ ⑨ | ■ |
| SFV 06030.06 | A 104 | 60   | 30   | 6    | 40   | 5.000            | 9.000          | A2203060306104 | ① ② ③ ④ ⑤ ⑥ ⑦ ⑧   | ■ |
| SFV 06030.06 | A 106 | 60   | 30   | 6    | 40   | 5.000            | 9.000          | A2203060306106 | ① ② ③ ④ ⑤ ⑥ ⑦ ⑧   | ■ |
| SFV 06030.06 | A 107 | 60   | 30   | 6    | 40   | 5.000            | 9.000          | A2203060306107 | ① ② ③ ④ ⑤ ⑥ ⑦ ⑧   | ■ |
| SFV 06030.06 | C 204 | 60   | 30   | 6    | 40   | 5.000            | 9.000          | A2203060306204 | ① ② ③ ④ ⑤ ⑥ ⑦ ⑧ ⑨ | ■ |
| SFV 06030.06 | C 206 | 60   | 30   | 6    | 40   | 5.000            | 9.000          | A2203060306206 | ① ② ③ ④ ⑤ ⑥ ⑦ ⑧ ⑨ | ■ |
| SFV 06030.06 | C 207 | 60   | 30   | 6    | 40   | 5.000            | 9.000          | A2203060306207 | ① ② ③ ④ ⑤ ⑥ ⑦ ⑧ ⑨ | ■ |
| SFV 06040.06 | A 104 | 60   | 40   | 6    | 40   | 5.000            | 9.000          | A2203060406104 | ① ② ③ ④ ⑤ ⑥ ⑦ ⑧   | ■ |
| SFV 06040.06 | A 106 | 60   | 40   | 6    | 40   | 5.000            | 9.000          | A2203060406106 | ① ② ③ ④ ⑤ ⑥ ⑦ ⑧   | ■ |
| SFV 06040.06 | A 107 | 60   | 40   | 6    | 40   | 5.000            | 9.000          | A2203060406107 | ① ② ③ ④ ⑤ ⑥ ⑦ ⑧   | ■ |
| SFV 06040.06 | C 204 | 60   | 40   | 6    | 40   | 5.000            | 9.000          | A2203060406204 | ① ② ③ ④ ⑤ ⑥ ⑦ ⑧ ⑨ | ■ |
| SFV 06040.06 | C 207 | 60   | 40   | 6    | 40   | 5.000            | 9.000          | A2203060406207 | ① ② ③ ④ ⑤ ⑥ ⑦ ⑧ ⑨ | ■ |
| SFV 06050.06 | A 104 | 60   | 50   | 6    | 40   | 5.000            | 9.000          | A2203060506104 | ① ② ③ ④ ⑤ ⑥ ⑦ ⑧   | ■ |

The stated maximum operating speed only applies to a maximum overhang  $L_0$  of 20 mm. Other overhang dimensions must be calculated separately.

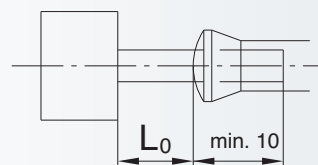



## SFV, Flap wheels of fleece flaps

Ordering example: A2203060506106

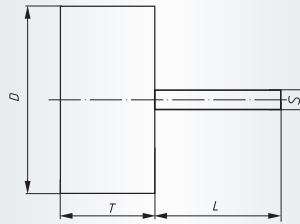
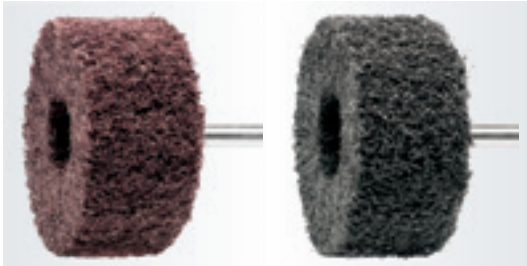

**Packing unit:**

10 pcs. per type

Further dimensions, qualities and shank lengths on request.

A = reg. Aluminium Oxide  
C = Silicon carbide

| Description  | Grits | D mm | T mm | S mm | L mm | n recom. (1/min) | n max. (1/min) | Product-Number | recommended for   |   |
|--------------|-------|------|------|------|------|------------------|----------------|----------------|-------------------|---|
| SFV 06050.06 | A 106 | 60   | 50   | 6    | 40   | 5.000            | 9.000          | A2203060506106 | ① ② ③ ④ ⑤ ⑥ ⑦ ⑧   | ■ |
| SFV 06050.06 | A 107 | 60   | 50   | 6    | 40   | 5.000            | 9.000          | A2203060506107 | ① ② ③ ④ ⑤ ⑥ ⑦ ⑧   | ■ |
| SFV 06050.06 | C 207 | 60   | 50   | 6    | 40   | 5.000            | 9.000          | A2203060506207 | ① ② ③ ④ ⑤ ⑥ ⑦ ⑧ ⑨ | ■ |
| SFV 08040.06 | A 104 | 80   | 40   | 6    | 40   | 4.000            | 7.000          | A2203080406104 | ① ② ③ ④ ⑤ ⑥ ⑦ ⑧   | ■ |
| SFV 08040.06 | A 106 | 80   | 40   | 6    | 40   | 4.000            | 7.000          | A2203080406106 | ① ② ③ ④ ⑤ ⑥ ⑦ ⑧   | ■ |
| SFV 08040.06 | C 204 | 80   | 40   | 6    | 40   | 4.000            | 7.000          | A2203080406204 | ① ② ③ ④ ⑤ ⑥ ⑦ ⑧ ⑨ | ■ |
| SFV 08040.06 | C 206 | 80   | 40   | 6    | 40   | 4.000            | 7.000          | A2203080406206 | ① ② ③ ④ ⑤ ⑥ ⑦ ⑧ ⑨ | ■ |
| SFV 08040.06 | C 207 | 80   | 40   | 6    | 40   | 4.000            | 7.000          | A2203080406207 | ① ② ③ ④ ⑤ ⑥ ⑦ ⑧ ⑨ | ■ |
| SFV 08050.06 | A 104 | 80   | 50   | 6    | 40   | 4.000            | 7.000          | A2203080506104 | ① ② ③ ④ ⑤ ⑥ ⑦ ⑧   | ■ |
| SFV 08050.06 | A 106 | 80   | 50   | 6    | 40   | 4.000            | 7.000          | A2203080506106 | ① ② ③ ④ ⑤ ⑥ ⑦ ⑧   | ■ |
| SFV 08050.06 | A 107 | 80   | 50   | 6    | 40   | 4.000            | 7.000          | A2203080506107 | ① ② ③ ④ ⑤ ⑥ ⑦ ⑧   | ■ |
| SFV 08050.06 | C 204 | 80   | 50   | 6    | 40   | 4.000            | 7.000          | A2203080506204 | ① ② ③ ④ ⑤ ⑥ ⑦ ⑧ ⑨ | ■ |
| SFV 08050.06 | C 206 | 80   | 50   | 6    | 40   | 4.000            | 7.000          | A2203080506206 | ① ② ③ ④ ⑤ ⑥ ⑦ ⑧ ⑨ | ■ |
| SFV 08050.06 | C 207 | 80   | 50   | 6    | 40   | 4.000            | 7.000          | A2203080506207 | ① ② ③ ④ ⑤ ⑥ ⑦ ⑧ ⑨ | ■ |

The stated maximum operating speed only applies to a maximum overhang  $L_0$  of 20 mm. Other overhang dimensions must be calculated separately.

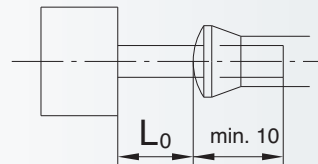

**SFR, Mounted fleece discs**

Ordering example: A2223060506104

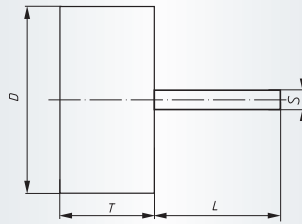

**Packing unit:**

10 pcs. per type

Further dimensions, qualities and shank lengths on request.

A = reg. Aluminium Oxide

| Description  | Grits | D mm | T mm | S mm | L mm | n recom. (1/min) | n max. (1/min) | Product-Number | recommended for |   |
|--------------|-------|------|------|------|------|------------------|----------------|----------------|-----------------|---|
| SFR 06050.06 | A 104 | 60   | 50   | 6    | 40   | 5.000            | 9.000          | A2223060506104 | 1 2 3 4 5 6 7 8 | ■ |
| SFR 06050.06 | A 106 | 60   | 50   | 6    | 40   | 5.000            | 9.000          | A2223060506106 | 1 2 3 4 5 6 7 8 | ■ |
| SFR 06050.06 | A 107 | 60   | 50   | 6    | 40   | 5.000            | 9.000          | A2223060506107 | 1 2 3 4 5 6 7 8 | ■ |
| SFR 08050.06 | A 104 | 80   | 50   | 6    | 40   | 4.000            | 7.000          | A2223080506104 | 1 2 3 4 5 6 7 8 | ■ |
| SFR 08050.06 | A 106 | 80   | 50   | 6    | 40   | 4.000            | 7.000          | A2223080506106 | 1 2 3 4 5 6 7 8 | ■ |
| SFR 08050.06 | A 107 | 80   | 50   | 6    | 40   | 4.000            | 7.000          | A2223080506107 | 1 2 3 4 5 6 7 8 | ■ |

The stated maximum operating speed only applies to a maximum overhang  $L_0$  of 20 mm. Other overhang dimensions must be calculated separately.

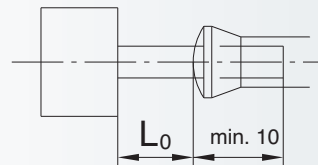

High Performance

SFM, Flap wheels of abrasive fleece TF with abrasive cloth

Ordering example: A2204040206120

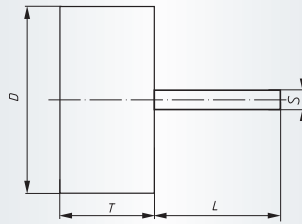
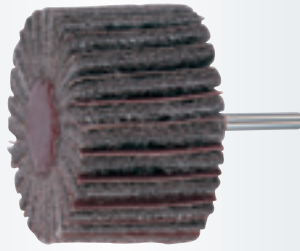

**Packing unit:**  
10 pcs. per type  
TF = Special quality for INOX

| Description  | Grits     | D mm | T mm | S mm | L mm | n recom. (1/min) | n max. (1/min) | Product-Number | recommended for |   |     |
|--------------|-----------|------|------|------|------|------------------|----------------|----------------|-----------------|---|-----|
| SFM 04020.06 | TF 120/80 | 40   | 20   | 6    | 40   | 7.500            | 14.000         | A2204040206120 | 1 2 3 4 5 6 7 8 | ■ | NEW |
| SFM 06030.06 | TF 120/80 | 60   | 30   | 6    | 40   | 5.000            | 9.000          | A2204060306120 | 1 2 3 4 5 6 7 8 | ■ | NEW |
| SFM 08050.06 | TF 120/80 | 80   | 50   | 6    | 40   | 4.000            | 7.000          | A2204080506120 | 1 2 3 4 5 6 7 8 | ■ | NEW |

Ideal for surface finishing of metalsheet components such as stainless steel sinks and containers.  
The stated maximum operating speed only applies to a maximum overhang  $L_0$  of 20 mm. Other overhang dimensions must be calculated separately.

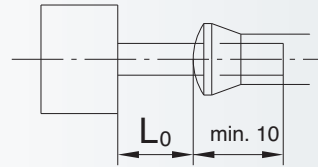

SFM, Flap wheels of abrasive fleece with abrasive cloth

Ordering example: A2204040206104

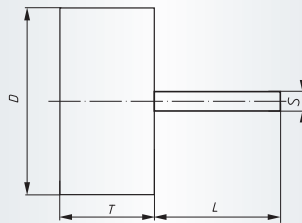
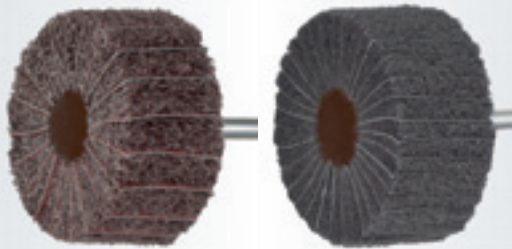

**Packing unit:**  
10 pcs. per type  
Further dimensions, qualities and shank lengths on request.  
A = reg. Aluminium Oxide  
C = Silicon carbide

| Description  | Grits     | D mm | T mm | S mm | L mm | n recom. (1/min) | n max. (1/min) | Product-Number | recommended for   |   |  |
|--------------|-----------|------|------|------|------|------------------|----------------|----------------|-------------------|---|--|
| SFM 04020.06 | A 104/80  | 40   | 20   | 6    | 40   | 7.500            | 14.000         | A2204040206104 | 1 2 3 4 5 6 7 8   | ■ |  |
| SFM 04020.06 | A 106/150 | 40   | 20   | 6    | 40   | 7.500            | 14.000         | A2204040206106 | 1 2 3 4 5 6 7 8   | ■ |  |
| SFM 04020.06 | A 107/240 | 40   | 20   | 6    | 40   | 7.500            | 14.000         | A2204040206107 | 1 2 3 4 5 6 7 8   | ■ |  |
| SFM 04020.06 | C 204/80  | 40   | 20   | 6    | 40   | 7.500            | 14.000         | A2204040206204 | 1 2 3 4 5 6 7 8 9 | ■ |  |
| SFM 04020.06 | C 206/150 | 40   | 20   | 6    | 40   | 7.500            | 14.000         | A2204040206206 | 1 2 3 4 5 6 7 8 9 | ■ |  |
| SFM 04030.06 | A 104/80  | 40   | 30   | 6    | 40   | 7.500            | 14.000         | A2204040306104 | 1 2 3 4 5 6 7 8   | ■ |  |
| SFM 04030.06 | A 106/150 | 40   | 30   | 6    | 40   | 7.500            | 14.000         | A2204040306106 | 1 2 3 4 5 6 7 8   | ■ |  |
| SFM 04030.06 | A 107/240 | 40   | 30   | 6    | 40   | 7.500            | 14.000         | A2204040306107 | 1 2 3 4 5 6 7 8   | ■ |  |
| SFM 04030.06 | C 204/80  | 40   | 30   | 6    | 40   | 7.500            | 14.000         | A2204040306204 | 1 2 3 4 5 6 7 8 9 | ■ |  |
| SFM 04030.06 | C 206/150 | 40   | 30   | 6    | 40   | 7.500            | 14.000         | A2204040306206 | 1 2 3 4 5 6 7 8 9 | ■ |  |

The stated maximum operating speed only applies to a maximum overhang  $L_0$  of 20 mm. Other overhang dimensions must be calculated separately.

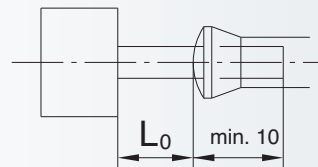

## SFM, Flap wheels of abrasive fleece with abrasive cloth

Ordering example: A2204040306207

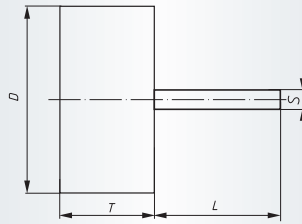
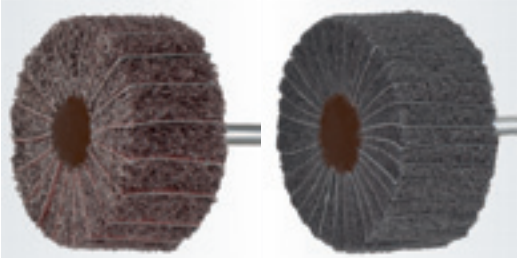

**Packing unit:**

10 pcs. per type

Further dimensions, qualities and shank lengths on request.

A = reg. Aluminium Oxide  
C = Silicon carbide

| Description  | Grits     | D mm | T mm | S mm | L mm | n recom. (1/min) | n max. (1/min) | Product-Number | recommended for   |   |
|--------------|-----------|------|------|------|------|------------------|----------------|----------------|-------------------|---|
| SFM 04030.06 | C 207/240 | 40   | 30   | 6    | 40   | 7.500            | 14.000         | A2204040306207 | ① ② ③ ④ ⑤ ⑥ ⑦ ⑧ ⑨ | ■ |
| SFM 05020.06 | A 104/80  | 50   | 20   | 6    | 40   | 6.000            | 11.000         | A2204050206104 | ① ② ③ ④ ⑤ ⑥ ⑦ ⑧   | ■ |
| SFM 05020.06 | A 106/150 | 50   | 20   | 6    | 40   | 6.000            | 11.000         | A2204050206106 | ① ② ③ ④ ⑤ ⑥ ⑦ ⑧   | ■ |
| SFM 05020.06 | C 206/150 | 50   | 20   | 6    | 40   | 6.000            | 11.000         | A2204050206206 | ① ② ③ ④ ⑤ ⑥ ⑦ ⑧ ⑨ | ■ |
| SFM 05030.06 | A 106/150 | 50   | 30   | 6    | 40   | 6.000            | 11.000         | A2204050306106 | ① ② ③ ④ ⑤ ⑥ ⑦ ⑧   | ■ |
| SFM 05030.06 | A 107/240 | 50   | 30   | 6    | 40   | 6.000            | 11.000         | A2204050306107 | ① ② ③ ④ ⑤ ⑥ ⑦ ⑧   | ■ |
| SFM 05040.06 | A 104/80  | 50   | 40   | 6    | 40   | 6.000            | 11.000         | A2204050406104 | ① ② ③ ④ ⑤ ⑥ ⑦ ⑧   | ■ |
| SFM 05040.06 | A 106/150 | 50   | 40   | 6    | 40   | 6.000            | 11.000         | A2204050406106 | ① ② ③ ④ ⑤ ⑥ ⑦ ⑧   | ■ |
| SFM 06030.06 | A 104/80  | 60   | 30   | 6    | 40   | 5.000            | 9.000          | A2204060306104 | ① ② ③ ④ ⑤ ⑥ ⑦ ⑧   | ■ |
| SFM 06030.06 | A 106/150 | 60   | 30   | 6    | 40   | 5.000            | 9.000          | A2204060306106 | ① ② ③ ④ ⑤ ⑥ ⑦ ⑧   | ■ |
| SFM 06030.06 | A 107/240 | 60   | 30   | 6    | 40   | 5.000            | 9.000          | A2204060306107 | ① ② ③ ④ ⑤ ⑥ ⑦ ⑧   | ■ |
| SFM 06030.06 | C 204/80  | 60   | 30   | 6    | 40   | 5.000            | 9.000          | A2204060306204 | ① ② ③ ④ ⑤ ⑥ ⑦ ⑧ ⑨ | ■ |
| SFM 06030.06 | C 206/150 | 60   | 30   | 6    | 40   | 5.000            | 9.000          | A2204060306206 | ① ② ③ ④ ⑤ ⑥ ⑦ ⑧ ⑨ | ■ |
| SFM 06030.06 | C 207/240 | 60   | 30   | 6    | 40   | 5.000            | 9.000          | A2204060306207 | ① ② ③ ④ ⑤ ⑥ ⑦ ⑧ ⑨ | ■ |
| SFM 06040.06 | A 104/80  | 60   | 40   | 6    | 40   | 5.000            | 9.000          | A2204060406104 | ① ② ③ ④ ⑤ ⑥ ⑦ ⑧   | ■ |
| SFM 06040.06 | A 106/150 | 60   | 40   | 6    | 40   | 5.000            | 9.000          | A2204060406106 | ① ② ③ ④ ⑤ ⑥ ⑦ ⑧   | ■ |
| SFM 06040.06 | A 107/240 | 60   | 40   | 6    | 40   | 5.000            | 9.000          | A2204060406107 | ① ② ③ ④ ⑤ ⑥ ⑦ ⑧   | ■ |
| SFM 06040.06 | C 204/80  | 60   | 40   | 6    | 40   | 5.000            | 9.000          | A2204060406204 | ① ② ③ ④ ⑤ ⑥ ⑦ ⑧ ⑨ | ■ |
| SFM 06050.06 | A 104/80  | 60   | 50   | 6    | 40   | 5.000            | 9.000          | A2204060506104 | ① ② ③ ④ ⑤ ⑥ ⑦ ⑧   | ■ |
| SFM 06050.06 | A 106/150 | 60   | 50   | 6    | 40   | 5.000            | 9.000          | A2204060506106 | ① ② ③ ④ ⑤ ⑥ ⑦ ⑧   | ■ |
| SFM 08040.06 | A 104/80  | 80   | 40   | 6    | 40   | 4.000            | 7.000          | A2204080406104 | ① ② ③ ④ ⑤ ⑥ ⑦ ⑧   | ■ |
| SFM 08040.06 | A 106/150 | 80   | 40   | 6    | 40   | 4.000            | 7.000          | A2204080406106 | ① ② ③ ④ ⑤ ⑥ ⑦ ⑧   | ■ |
| SFM 08040.06 | A 107/240 | 80   | 40   | 6    | 40   | 4.000            | 7.000          | A2204080406107 | ① ② ③ ④ ⑤ ⑥ ⑦ ⑧   | ■ |
| SFM 08040.06 | C 206/150 | 80   | 40   | 6    | 40   | 4.000            | 7.000          | A2204080406206 | ① ② ③ ④ ⑤ ⑥ ⑦ ⑧ ⑨ | ■ |
| SFM 08050.06 | A 104/80  | 80   | 50   | 6    | 40   | 4.000            | 7.000          | A2204080506104 | ① ② ③ ④ ⑤ ⑥ ⑦ ⑧   | ■ |
| SFM 08050.06 | A 106/150 | 80   | 50   | 6    | 40   | 4.000            | 7.000          | A2204080506106 | ① ② ③ ④ ⑤ ⑥ ⑦ ⑧   | ■ |
| SFM 08050.06 | A 107/240 | 80   | 50   | 6    | 40   | 4.000            | 7.000          | A2204080506107 | ① ② ③ ④ ⑤ ⑥ ⑦ ⑧   | ■ |
| SFM 08050.06 | C 204/80  | 80   | 50   | 6    | 40   | 4.000            | 7.000          | A2204080506204 | ① ② ③ ④ ⑤ ⑥ ⑦ ⑧ ⑨ | ■ |
| SFM 08050.06 | C 206/150 | 80   | 50   | 6    | 40   | 4.000            | 7.000          | A2204080506206 | ① ② ③ ④ ⑤ ⑥ ⑦ ⑧ ⑨ | ■ |

The stated maximum operating speed only applies to a maximum overhang  $L_0$  of 20 mm. Other overhang dimensions must be calculated separately.

